

# Front Handle One-Piece, Width 12.2 mm

## Power Utilities

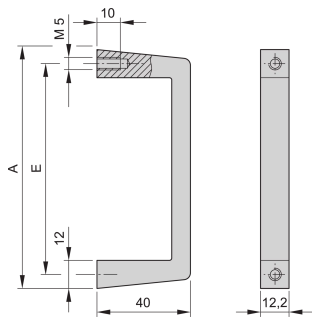

The handle can be assembled to a subrack or 19" front panel. Available with clear or black anodized surface. Handles will be bolted from the rear side.

## CERTIFICATIONS



## FEATURES

Static load-carrying capacity 30 kg/pair

Bolted from rear

## SPECIFICATIONS

Table 1/2

Catalog Number	Rack Height	Package Quantity	Handle Type	Color	Material	Product Family
10501-116	1 U	1	Straight	Silver	Aluminum	EuropacPRO
10501-029	6 U	1	Straight	Black	Aluminum	EuropacPRO
10501-022	6 U	1	Angled Handle	Silver	Aluminum	EuropacPRO

CatalogNumber	Rack Height	Package Quantity	Handle Type	Color	Material	Product Family
10501-008	6 U	1	Straight	Silver	Aluminum	EuropacPRO
10501-007	5 U	1	Straight	Silver	Aluminum	EuropacPRO
10501-016	2 U	1	Straight	Silver	Aluminum	EuropacPRO
10501-006	4 U	1	Straight	Silver	Aluminum	EuropacPRO
10501-021	4 U	1	Angled Handle	Silver	Aluminum	EuropacPRO
10501-005	3 U	1	Straight	Silver	Aluminum	EuropacPRO
10501-018	4 U	1	Straight	Silver	Aluminum	EuropacPRO
10501-025	2 U	1	Straight	Black	Aluminum	EuropacPRO
10501-026	3 U	1	Straight	Black	Aluminum	EuropacPRO
10501-020	3 U	1	Angled Handle	Silver	Aluminum	EuropacPRO
10501-027	4 U	1	Straight	Black	Aluminum	EuropacPRO
10501-004	2 U	1	Straight	Silver	Aluminum	EuropacPRO
10501-028	5 U	1	Straight	Black	Aluminum	EuropacPRO

Table 2/2			
Catalog Number	Product Type	Works With	Torque
10501-116	Handle	Subracks	
10501-029	Handle	Subracks	2.4 N·m
10501-022	Handle	Subracks	2.4 N·m
10501-008	Handle	Subracks	2.4 N·m

Catalog Number	Product Type	Works With	Torque
10501-007	Handle	Subracks	
10501-016	Handle	Subracks	
10501-006	Handle	Subracks	
10501-021	Handle	Subracks	2.4 N·m
10501-005	Handle	Subracks	2.4 N·m
10501-018	Handle	Subracks	2.4 N·m
10501-025	Handle	Subracks	
10501-026	Handle	Subracks	2.4 N·m
10501-020	Handle	Subracks	2.4 N·m
10501-027	Handle	Subracks	
10501-004	Handle	Subracks	
10501-028	Handle	Subracks	

## ADDITIONAL PRODUCT DETAILS

Please order assembly part kit separately.

Please take into consideration that deliveries may be carried out in the stated SPQs (SPQ, e.g. 5 pieces, 10 pieces, 50 pieces, etc.). Differing order quantities (e.g. 2 pieces) may be changed to the next possible delivery quantity = Standard Pack Quantity.

## WARNING

nVent products shall be installed and used only as indicated in nVent's product instruction sheets and training materials. Instruction sheets are available at [www.nvent.com](http://www.nvent.com) and from your nVent customer service representative. Improper installation, misuse, misapplication or other failure to completely follow nVent's instructions and warnings may cause product malfunction, property damage, serious bodily injury and death and/or void your warranty.



Our powerful portfolio of brands:

**CADDY   ERICO   HOFFMAN   ILSCO   SCHROFF   TRACHTE**