

2 Hole Lug, 120.65 mm x 38.1 mm x 9.53 mm, 14.29 mm Hole

Data Solutions

CATALOG NUMBER

B102GG

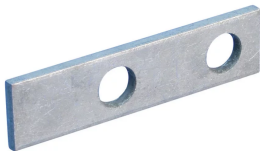

FEATURES

Provides an efficient bolting surface for grounding and power applications

Electrolytic grade copper

For use with nVent ERICO Cadweld type LA connections only

PRODUCT ATTRIBUTES

Material: Copper

Finish: Tinned

Type: NEMA®

Length (L): 120.65mm

Width (W): 38.1mm

Thickness (T): 9.53mm

A: 15.9mm

B: 44.45mm

Hole Size (HS): 14.29mm

Equivalent Conductor Size: 362.83mm²

ADDITIONAL PRODUCT DETAILS

For sizes not listed, contact us.

DIAGRAMS

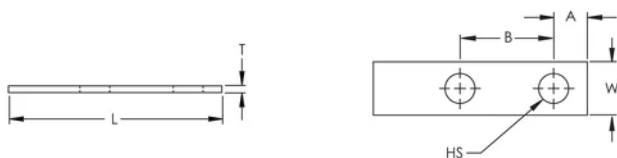

WARNING

nVent products shall be installed and used only as indicated in nVent's product instruction sheets and training materials. Instruction sheets are available at www.nvent.com and from your nVent customer service representative. Improper installation, misuse, misapplication or other failure to completely follow nVent's instructions and warnings may cause product malfunction, property damage, serious bodily injury and death and/or void your warranty.



Our powerful portfolio of brands:

CADDY ERICO HOFFMAN ILSCO SCHROFF TRACHTE