

2 Hole Telecom Lug

Data Solutions



FEATURES

Provides an efficient bolting surface for grounding and power applications

Electrolytic grade copper

Hole spacing for telecom ground bars

For use with nVent ERICO Cadweld mold GLPCC001TC only

SPECIFICATIONS

Material: Copper

Finish: Tinned

Table 1/2

Catalog Number	Height (H)	Length (L)	Width (W)	Thickness (T)	A	B
B922CC14A	7.93mm	47.63mm	15.88mm	3.18mm	9.5mm	15.88mm
B922CC14B	7.93mm	47.63mm	15.88mm	3.18mm	9.5mm	19.05mm
B922CC14C	7.93mm	47.63mm	15.88mm	3.18mm	9.5mm	25.4mm
B922CC38B	7.93mm	47.63mm	15.88mm	3.18mm	9.5mm	19.05mm

CatalogNumber	Height (H)	Length (L)	Width (W)	Thickness (T)	A	B
B922CC38C	7.93mm	47.63mm	15.88mm	3.18mm	9.5mm	25.4mm
B922CE716B	11.18mm	47.63mm	25.4mm	3.18mm	15.9mm	19.05mm

Table 2/2

Catalog Number	Hole Size (HS)	Angle (a)	Equivalent Conductor Size
B922CC14A	7.14mm	90°	50.39mm ²
B922CC14B	7.14mm	90°	50.39mm ²
B922CC14C	7.14mm	90°	50.39mm ²
B922CC38B	7.14mm	90°	50.39mm ²
B922CC38C	7.14mm	90°	50.39mm ²
B922CE716B	7.14mm	90°	80.63mm ²

ADDITIONAL PRODUCT DETAILS

For sizes not listed, contact us.

DIAGRAMS

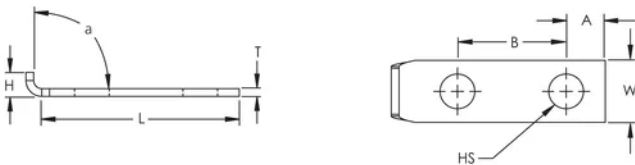

WARNING

nVent products shall be installed and used only as indicated in nVent's product instruction sheets and training materials. Instruction sheets are available at www.nvent.com and from your nVent customer service representative. Improper installation, misuse, misapplication or other failure to completely follow nVent's instructions and warnings may cause product malfunction, property damage, serious bodily injury and death and/or void your warranty.



Our powerful portfolio of brands:

CADDY ERICO HOFFMAN ILSCO SCHROFF TRACHTE