

1 Hole Telecom Lug

Data Solutions



FEATURES

Provides an efficient bolting surface for grounding and power applications

Electrolytic grade copper

For use with nVent ERICO Cadweld mold GLPCC001TC only

SPECIFICATIONS

Material: Copper

Finish: Tinned

Table 1/2

Catalog Number	Height (H)	Length (L)	Width (W)	Thickness (T)	A	Hole Size (HS)
B921CC14	7.93mm	22.23mm	15.88mm	3.18mm	9.5mm	7.14mm
B921CC38	7.93mm	22.23mm	15.88mm	3.18mm	9.5mm	10.32mm
B921CC516	7.93mm	22.23mm	15.88mm	3.18mm	9.5mm	8.73mm

Table 2/2

Catalog Number	Angle (a)	Equivalent Conductor Size
----------------	-----------	---------------------------

B921CC14	90°	50.39mm ²
B921CC38	90°	50.39mm ²
B921CC516	90°	50.39mm ²

ADDITIONAL PRODUCT DETAILS

For sizes not listed, contact us.

DIAGRAMS

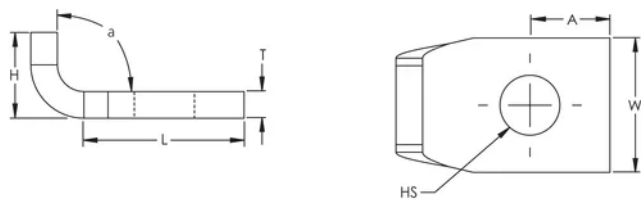

WARNING

nVent products shall be installed and used only as indicated in nVent's product instruction sheets and training materials. Instruction sheets are available at www.nvent.com and from your nVent customer service representative. Improper installation, misuse, misapplication or other failure to completely follow nVent's instructions and warnings may cause product malfunction, property damage, serious bodily injury and death and/or void your warranty.



Our powerful portfolio of brands:

CADDY ERICO HOFFMAN ILSCO SCHROFF TRACHTE