

Quick Grip Lateral Sway Brace



The Quick Grip Lateral Brace, part of the nVent CADDY line of fire sprinkler bracing systems from nVent, is designed to help simplify installations when bracing service pipe for seismic or other catastrophic events. It features an innovative design for quick attachment of brace pipe to service pipe saving time and money.

CERTIFICATIONS



FEATURES

Easy two-step installation eliminates extra trips between structure and service pipe

Works with 1" and 1 1/4" (25 mm and 32 mm) brace pipes to reduce inventory

Yellow tips provide a visual indicator that the bolts have been properly torqued

Easy installation with an impact wrench from the bottom side of the clamp

Meets NFPA®-13 requirements for seismic sway bracing

Meets CEN/TS 17551:2021 requirements for Seismic Sway Bracing

SPECIFICATIONS

Finish: Electrogalvanized

Material: Steel

Table 1/1

Catalog Number	Article Number	NB/DN	Height (H)	Width (W)	Certifications
CSBQG0250EG	404468	65	138.10 - 148.6 mm	172 mm	OSHPD, FM Approved, Seismic, cUL, UL

Catalog Number	Article Number	NB/DN	Height (H)	Width (W)	Certifications
CSBQG0300EG	404469	80	155.00 - 165.5 mm	190 mm	OSHPD/HCAI, AON Fire Protection, Rigid Seismic, cUL, FM Approved, Seismic, UL
CSBQG0400EG	404470	100	180.40 - 190.9 mm	222 mm	UL, cUL, FM Approved, Seismic, OSHPD/HCAI, AON Fire Protection, Rigid Seismic
CSBQG0600EG	404472	150	235.50 - 244.9 mm	298 mm	cUL, OSHPD, AON Fire Protection, Rigid Seismic, FM Approved, Seismic, UL
CSBQG0800EG	404473	200	289.2 - 300 mm	351.8 mm	FM Approved, Seismic, AON Fire Protection, Rigid Seismic, OSHPD/HCAI, cUL, UL

UL Loads				
Part Number	Lateral			
	Sch 10/Sch 40 Service Pipe	Bull Moose Eddy Flow Service Pipe	Wheatland Mega-Flow Service Pipe	Youngstown Fire-Flo Service Pipe
CSBQG0250	6672 N	6672 N	6672 N	6672 N
CSBQG0300	5782 N	5782 N	5782 N	5782 N
CSBQG0400	6672 N	6672 N	6672 N	6672 N
CSBQG0500	N/A	N/A	N/A	N/A
CSBQG0600	6227 N	N/A	6227 N	N/A
CSBQG0800	6227 N	N/A	N/A	N/A

FM Loads					
Part Number	Service Pipe Schedule	Lateral			
		Horizontal Capacity per Installation Angle from Vertical			
		30° - 44°	45° - 59°	60° - 74°	75° - 90°
CSBQG0250EG/ CSBQG0250MEG	EN10255 L (Lightwall)	6270 N	8895 N	10900 N	12190 N
	EN10255 M (10)	6270 N	8895 N	10900 N	12190 N
	EN10255 H (40)	6270 N	8895 N	10900 N	12190 N
CSBQG0300EG	EN10255 L (Lightwall)	5295 N	7475 N	9163 N	10230 N
	EN10255 M (10)	5295 N	7475 N	9163 N	10230 N
	EN10255 H (40)	5295 N	7475 N	9163 N	10230 N
CSBQG0400EG	EN10255 L (Lightwall)	5295 N	7475 N	9163 N	10230 N
	EN10255 M (10)	5295 N	7475 N	9163 N	10230 N
	EN10255 H (40)	5295 N	7475 N	9163 N	10230 N
CSBQG0600EG	EN10255 L (Lightwall)	3870 N	5470 N	6715 N	7515 N
	EN10255 M (10)	3870 N	5470 N	6715 N	7515 N
	EN10255 H (40)	4315 N	6095 N	7475 N	8320 N
CSBQG0800EG	4.8 mm (Wall Thickness)	3515 N	4940 N	6050 N	6760 N
	EN10255 H (40)	3515 N	4940 N	6050 N	6760 N

DIAGRAMS

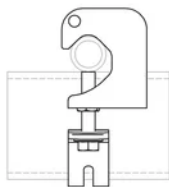
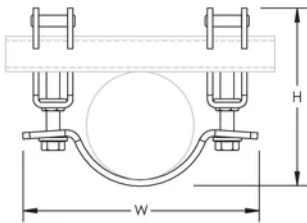

WARNING

nVent products shall be installed and used only as indicated in nVent's product instruction sheets and training materials. Instruction sheets are available at www.nvent.com and from your nVent customer service representative. Improper installation, misuse, misapplication or other failure to completely follow nVent's instructions and warnings may cause product malfunction, property damage, serious bodily injury and death and/or void your warranty.

North America

+1.800.753.9221

Option 1 – Customer Care

Option 2 – Technical

Support

Europe

Netherlands:

+31 800-0200135

France:

+33 800 901 793

Europe

Germany:

800 1890272

Other Countries:

+31 13 5835404

APAC

Shanghai:

+ 86 21 2412 1618/19

Sydney:

+61 2 9751 8500



Our powerful portfolio of brands:

CADDY

ERICO

HOFFMAN

ILSCO

SCHROFF

TRACHTE

