

# CFFW Tapered Screw-In Plug for A2 Couplers

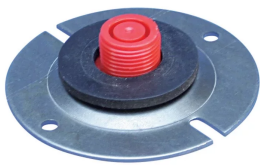

## FEATURES

Designed for use with the A2 coupler families

Designed to keep dirt, water and concrete slurry out of the coupler during the concrete pour

Durable mounting plates allow for easy attachment to forms

Color coded for the appropriate coupler size

## SPECIFICATIONS

Table 1/2

Catalog Number	Rebar Size, Metric	Rebar Size, US	Rebar Size, Canada	Diameter 1 (Ø1)	Diameter 2 (Ø2)	Height (H)
EL22CFFW	22 mm	#7		75 mm	43 mm	18 mm
EL25CFFW	25 mm	#8	25M	75 mm	46 mm	18 mm
EL28CFFW	28 mm	#9	30M	75 mm	50 mm	18 mm
EL32CFFW	32 mm	#10		95 mm	54 mm	18 mm

Table 2/2

Catalog Number	Thickness (T)	Color
EL22CFFW	3 mm	Blue

Catalog Number	Thickness (T)	Color
EL25CFFW	3 mm	Red
EL28CFFW	3 mm	Black
EL32CFFW	3 mm	Yellow

## DIAGRAMS

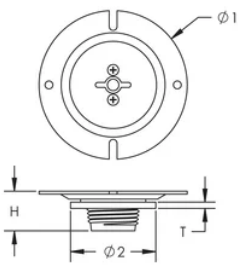

## WARNING

nVent products shall be installed and used only as indicated in nVent's product instruction sheets and training materials. Instruction sheets are available at [www.nvent.com](http://www.nvent.com) and from your nVent customer service representative. Improper installation, misuse, misapplication or other failure to completely follow nVent's instructions and warnings may cause product malfunction, property damage, serious bodily injury and death and/or void your warranty.

### North America

+1.800.753.9221  
Option 1 – Customer Care  
Option 2 – Technical  
Support

### Europe

Netherlands:  
+31 800-0200135  
France:  
+33 800 901 793

### Europe

Germany:  
800 1890272  
Other Countries:  
+31 13 5835404

### APAC

Shanghai:  
+ 86 21 2412 1618/19  
Sydney:  
+61 2 9751 8500



Our powerful portfolio of brands:

**CADDY   ERICO   HOFFMAN   ILSCO   SCHROFF   TRACHTE**