

Cable Clamp

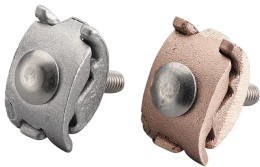

CERTIFICATIONS



FEATURES

Clamps to flat metal objects such as I-beams, angle irons and channel irons

Can be used as a parallel conductor clamp

Positive bolt tension draws tight on steel member

Listed to UL® 96

SPECIFICATIONS

Conductor Size, UL: Class 1 - Class 2 (4/0 Max);Secondary

Table 1/2

Catalog Number	Material	Finish	Flange Thickness (FT)	Depth (D)	Width (W)	Unit Weight
LPA858	Aluminum		12.7 mm Max	42.16mm	22.6 mm	0.05 kg
LPC858	Brass		12.7 mm Max	42.16mm	22.6 mm	0.11 kg

CatalogNumber	Material	Finish	Flange Thickness (FT)	Depth (D)	Width (W)	Unit Weight
LPC858L	Brass	Tinned	12.7 mm Max	42.16mm	22.6 mm	0.11 kg

Table 2/2	
Catalog Number	Certifications
LPA858	
LPC858	
LPC858L	E202878-Combined_CoC, E202878-Combined_CoC

ADDITIONAL PRODUCT DETAILS

Flange thickness will impact the maximum cable holding capability.

DIAGRAMS

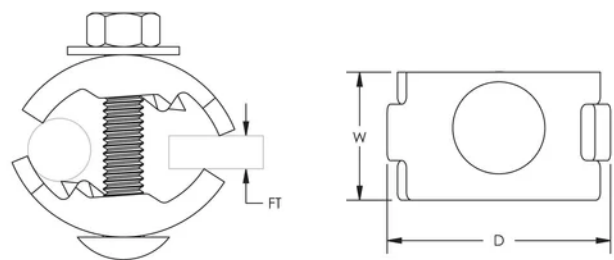

WARNING

nVent products shall be installed and used only as indicated in nVent's product instruction sheets and training materials. Instruction sheets are available at www.nvent.com and from your nVent customer service representative. Improper installation, misuse, misapplication or other failure to completely follow nVent's instructions and warnings may cause product malfunction, property damage, serious bodily injury and death and/or void your warranty.

⚠ WARNING: This product can expose you to chemicals including lead, which is known to the State of California to cause cancer and birth defects or other reproductive harm. For more information go to www.P65Warnings.ca.gov.

North America

+1.800.753.9221

Option 1 – Customer Care

Option 2 – Technical

Support

Europe

Netherlands:

+31 800-0200135

France:

+33 800 901 793

Europe

Germany:

800 1890272

Other Countries:

+31 13 5835404

APAC

Shanghai:

+ 86 21 2412 1618/19

Sydney:

+61 2 9751 8500



Our powerful portfolio of brands:

CADDY

ERICO

HOFFMAN

ILSCO

SCHROFF

TRACHTE