

Ground Rod to Lug or Busbar

Data Solutions

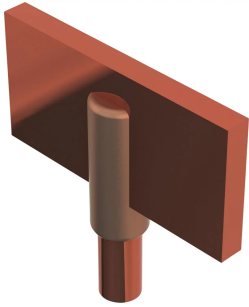

nVent ERICO Cadweld graphite molds are designed and engineered for thousands of connection styles and conductor combinations.

CERTIFICATIONS

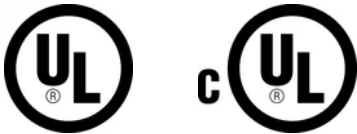

FEATURES

Forms a permanent, low resistance connection

Provides a molecular bond

nVent ERICO Cadweld Exothermic Connections are rated with the same current capacity as the conductor

Portable installation equipment with no external source of power required

Installers can be easily trained to make nVent ERICO Cadweld Exothermic Connections

Connections can be visually inspected

Mold Families LA and LE can be used with straight or offset lugs

SPECIFICATIONS

Table 1/2

Catalog Number	Article Number	Mold Family	Ground Rod Type	Ground Rod Diameter, Nominal	Ground Rod Diameter, Actual	Lug/Busbar Size
----------------	----------------	-------------	-----------------	------------------------------	-----------------------------	-----------------

LAC18EK		LA (To Ground Rod) Mold Family	Copper-bonded	0.75in	17.3mm	1/4" x 3" and wider
CMC14EAJ		CM Mold Family	Steel	0.5in	12.83mm	4 mm x 25 mm
CMC14EAL		CM Mold Family	Steel	0.5in	12.83mm	4 mm x 40 mm
CMC14EAM		CM Mold Family	Steel	0.5in	12.83mm	4 mm x 50 mm
CMC14FAM		CM Mold Family	Steel	0.5in	12.83mm	5 mm x 50 mm
CNC14EAJ		CN Mold Family	Steel	0.5in	12.83mm	4 mm x 25 mm
CNC14EAM		CN Mold Family	Steel	0.5in	12.83mm	4 mm x 50 mm
CSE14EG		CS Mold Family	Steel	0.5in	12.83mm	1/4" x 1 1/2"
CMC16CAJ		CM Mold Family	Copper-bonded	0.625in	14.3mm	3 mm x 25 mm
CMC16CAM		CM Mold Family	Copper-bonded	0.625in	14.3mm	3 mm x 50 mm
CMC16EAJ		CM Mold Family	Copper-bonded	0.625in	14.3mm	4 mm x 25 mm
CMC16EAL		CM Mold Family	Copper-bonded	0.625in	14.3mm	4 mm x 40 mm
CMC16EH		CM Mold Family	Copper-bonded	0.625in	14.3mm	1/4" x 2"
CMC16PAJ		CM Mold Family	Copper-bonded	0.625in	14.3mm	6 mm x 25 mm
CMC16PAL		CM Mold Family	Copper-bonded	0.625in	14.3mm	6 mm x 40 mm
CMC16PAM		CM Mold Family	Copper-bonded	0.625in	14.3mm	6 mm x 50 mm
CNC16CAJ		CN Mold Family	Copper-bonded	0.625in	14.3mm	3 mm x 25 mm
CNC16CAK		CN Mold Family	Copper-bonded	0.625in	14.3mm	3 mm x 30 mm
CNC16EAM		CN Mold Family	Copper-bonded	0.625in	14.3mm	4 mm x 50 mm

CNC16FAL		CN Mold Family	Copper-bonded	0.625in	14.3mm	5 mm x 40 mm
CPC16BAH		CP Mold Family	Copper-bonded	0.625in	14.3mm	2 mm x 20 mm
CPC16CAJ		CP Mold Family	Copper-bonded	0.625in	14.3mm	3 mm x 25 mm and wider
CPC16EAJ		CP Mold Family	Copper-bonded	0.625in	14.3mm	4 mm x 25 mm and wider
CQR16CAH		CQ Mold Family	Copper-bonded	0.625in	14.3mm	3 mm x 20 mm
CRC16CE		CR Mold Family	Copper-bonded	0.625in	14.3mm	1/8" x 1"
CRC16EK		CR Mold Family	Copper-bonded	0.625in	14.3mm	1/4" x 3" and wider
CRC16FAM		CR Mold Family	Copper-bonded	0.625in	14.3mm	5 mm x 50 mm and wider
CRC16PAM		CR Mold Family	Copper-bonded	0.625in	14.3mm	6 mm x 50 mm and wider
CSE16EAJ		CS Mold Family	Copper-bonded	0.625in	14.3mm	4 mm x 25 mm
CSE16EAM		CS Mold Family	Copper-bonded	0.625in	14.3mm	4 mm x 50 mm
CMCP160CAJ		CM Mold Family	Steel	16in	16mm	3 mm x 25 mm
CRCP160CAJ		CR Mold Family	Steel	16in	16mm	3 mm x 25 mm
CMC18CAJ		CM Mold Family	Copper-bonded	0.75in	17.32mm	3 mm x 25 mm
CMC18CAL		CM Mold Family	Copper-bonded	0.75in	17.32mm	3 mm x 40 mm
CNC18CAJ		CN Mold Family	Copper-bonded	0.75in	17.32mm	3 mm x 25 mm
CNC18CAK		CN Mold Family	Copper-bonded	0.75in	17.32mm	3 mm x 30 mm
CNC18CAL		CN Mold Family	Copper-bonded	0.75in	17.32mm	3 mm x 40 mm
CNC18EAL		CN Mold Family	Copper-bonded	0.75in	17.32mm	4 mm x 40 mm

CPC18CAJ		CP Mold Family	Copper-bonded	0.75in	17.32mm	3 mm x 25 mm and wider
CPC18EAJ		CP Mold Family	Copper-bonded	0.75in	17.32mm	4 mm x 25 mm and wider
CRC18BAL		CR Mold Family	Copper-bonded	0.75in	17.32mm	2 mm x 40 mm and wider
CRC18EAL		CR Mold Family	Copper-bonded	0.75in	17.32mm	4 mm x 40 mm and wider
CRC18EH		CR Mold Family	Copper-bonded	0.75in	17.32mm	1/4" x 2" and wider
CRD18EK		CR Mold Family	Copper-bonded	0.75in	17.32mm	1/4" x 3" and wider
CNCP180FAM		CN Mold Family	Steel	18in	18mm	5 mm x 50 mm
CQRP190CAJ		CQ Mold Family	Steel	19in	19mm	3 mm x 25 mm
CMCP200CAJ	238133	CM Mold Family	Steel	20in	20mm	3 mm x 25 mm
CNCP200CAK		CN Mold Family	Steel	20in	20mm	3 mm x 30 mm
CQFP200FAN		CQ Mold Family	Steel	20in	20mm	5 mm x 60 mm
CQRP200PAJ		CQ Mold Family	Steel	20in	20mm	6 mm x 25 mm
CMC22CAJ		CM Mold Family	Copper-bonded	1in	23.22mm	3 mm x 25 mm
CMD22FAM		CM Mold Family	Copper-bonded	1in	23.22mm	5 mm x 50 mm

Table 2/2

Catalog Number	Article Number	Certifications
LAC18EK		
CMC14EAJ		
CMC14EAL		
CMC14EAM		

Catalog Number	Article Number	Certifications
CMC14FAM		
CNC14EAJ		
CNC14EAM		
CSE14EG		
CMC16CAJ		
CMC16CAM		
CMC16EAJ		
CMC16EAL		
CMC16EH		
CMC16PAJ		
CMC16PAL		
CMC16PAM		
CNC16CAJ		
CNC16CAK		
CNC16EAM		
CNC16FAL		
CPC16BAH		
CPC16CAJ		

Catalog Number	Article Number	Certifications
CPC16EAJ		
CQR16CAH		
CRC16CE		
CRC16EK		
CRC16FAM		
CRC16PAM		
CSE16EAJ		
CSE16EAM		
CMCP160CAJ		
CRCP160CAJ		
CMC18CAJ		
CMC18CAL		
CNC18CAJ		
CNC18CAK		
CNC18CAL		
CNC18EAL		
CPC18CAJ		
CPC18EAJ		

Catalog Number	Article Number	Certifications
CRC18BAL		UL, cUL
CRC18EAL		
CRC18EH		
CRD18EK		
CNCP180FAM		
CQRP190CAJ		
CMCP200CAJ	238133	
CNCP200CAK		
CQFP200FAN		
CQRP200PAJ		
CMC22CAJ		
CMD22FAM		

ADDITIONAL PRODUCT DETAILS

For applications such as computer room, tunnel or other low-ventilation areas, specify a smokeless nVent ERICO Cadweld Exolon mold. Add an XL prefix to the standard mold part number when ordering (for example, a TAC2Q2Q becomes XLTAC2Q2Q). Similarly, nVent ERICO Cadweld Exolon welding material is also designated by the XL prefix (for example, 150 becomes XL150).

A gap between conductors may be required. See mold tag for more information.

XX-X-XX-XX-L-M-W		
XX	Mold Family	
X	Price Key	
XX	Ground Rod Code	
XX	Lug/Busbar Size	
L*	Split Crucible	Crucible section is split on molds designed with horizontal opening for easier cleaning
M*	Mold Only	
W*	Wear Plates	Reduce mechanical abrasion of molds at cable entry points

* Empty if none

WARNING

nVent products shall be installed and used only as indicated in nVent's product instruction sheets and training materials. Instruction sheets are available at www.nvent.com and from your nVent customer service representative. Improper installation, misuse, misapplication or other failure to completely follow nVent's instructions and warnings may cause product malfunction, property damage, serious bodily injury and death and/or void your warranty.



Our powerful portfolio of brands:

CADDY ERICO HOFFMAN ILSCO SCHROFF TRACHTE