

# PBF Two Hole Base Plate for Threaded Rod



## FEATURES

Light duty with two holes and one nut/adaptor

## SPECIFICATIONS

**Finish:** Electrogalvanized

**Material:** Steel

Table 1/2

Catalog Number	Article Number	Rod Size (RS)	Length (L)	Width (W)	Thickness (T)	A
PBRM10L80	587135	10	80mm	30 mm	3 mm	50 mm
PBRM8M10L80	587145	8, 10	80mm	30 mm	3 mm	50 mm
PBRM10L120	587160	10	120mm	40 mm	4 mm	81 mm
PBRM12L120	587165	12	120mm	40 mm	4 mm	81 mm
PBRM8M10L120	587140	8, 10	120mm	40 mm	4 mm	81 mm

Table 2/2

Catalog Number	Article Number	B	C
----------------	----------------	---	---

PBRM10L80	587135	18 mm	9 mm
PBRM8M10L80	587145	18 mm	9 mm
PBRM10L120	587160	18 mm	11 mm
PBRM12L120	587165	18 mm	11 mm
PBRM8M10L120	587140	18 mm	11 mm

### DIAGRAMS

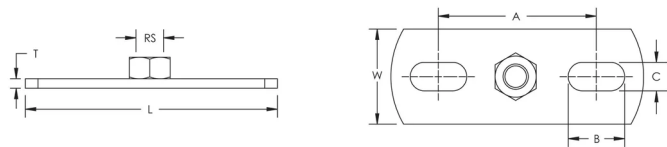

### WARNING

nVent products shall be installed and used only as indicated in nVent's product instruction sheets and training materials. Instruction sheets are available at [www.nvent.com](http://www.nvent.com) and from your nVent customer service representative. Improper installation, misuse, misapplication or other failure to completely follow nVent's instructions and warnings may cause product malfunction, property damage, serious bodily injury and death and/or void your warranty.

#### North America

+1.800.753.9221  
Option 1 – Customer Care  
Option 2 – Technical  
Support

#### Europe

Netherlands:  
+31 800-0200135  
France:  
+33 800 901 793

#### Europe

Germany:  
800 1890272  
Other Countries:  
+31 13 5835404

#### APAC

Shanghai:  
+ 86 21 2412 1618/19  
Sydney:  
+61 2 9751 8500



Our powerful portfolio of brands:

CADDY   ERICO   HOFFMAN   ILSCO   SCHROFF   TRACHTE

