

410 Clevis Hanger, Light Duty



CERTIFICATIONS



FEATURES

Recommended for the suspension of stationary non-insulated pipe lines

Also commonly used for the suspension of insulated pipe lines

Flared edges help prevent sharp surfaces from coming into contact with the pipe (1/2" to 8" pipe sizes)

Clevis bottom pivots to allow pipe to be fed from either direction

Conforms with Federal Specification WW-H-171 (Type 12), Manufacturers Standardization Society (MSS) SP-58 (Type 1)

SPECIFICATIONS

Finish: Electrogalvanized; Pregalvanized

Material: Steel

Table 1/2

Catalog Number	Article Number	NB/DN	Outer Diameter (OD)	Rod Size (RS)	A	B
4100100EG	179400	25	34 mm	M10	71 mm	35 mm
4100125EG	179401	32	43 mm	M10	80 mm	40 mm

CatalogNumber	Article Number	NB/DN	Outer Diameter (OD)	Rod Size (RS)	A	B
4100150EG	179402	40	48 mm	M10	94 mm	53 mm
4100200EG	179403	50	60 mm	M10	110 mm	63 mm
4100250EG	179404	65	73 mm	M12	134 mm	78 mm
4100300EG	179405	80	89 mm	M12	154 mm	90 mm
4100400EG	179406	100	114 mm	M16	189 mm	111 mm
4100500EG	179407	125	140 mm	M16	231 mm	130 mm
4100600EG	179408	150	165 mm	M20	268 mm	153 mm
4100800EG	179409	200	219 mm	M20	340 mm	193 mm

Table 2/2			
Catalog Number	Article Number	C	Static Load
4100100EG	179400	9 mm	1100N
4100125EG	179401	9 mm	1100N
4100150EG	179402	17 mm	1100N
4100200EG	179403	22 mm	1100N
4100250EG	179404	25 mm	1550N
4100300EG	179405	29 mm	1550N
4100400EG	179406	35 mm	2200N
4100500EG	179407	41 mm	2670N
4100600EG	179408	48 mm	3550N

Catalog Number	Article Number	C	Static Load
4100800EG	179409	62 mm	5300N

DIAGRAMS

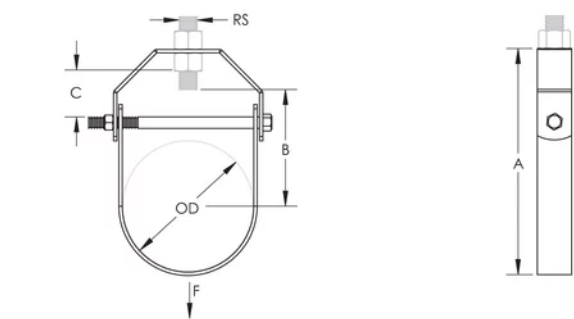

WARNING

nVent products shall be installed and used only as indicated in nVent's product instruction sheets and training materials. Instruction sheets are available at www.nvent.com and from your nVent customer service representative. Improper installation, misuse, misapplication or other failure to completely follow nVent's instructions and warnings may cause product malfunction, property damage, serious bodily injury and death and/or void your warranty.

North America

+1.800.753.9221
 Option 1 – Customer Care
 Option 2 – Technical
 Support

Europe

Netherlands:
 +31 800-0200135
 France:
 +33 800 901 793

Europe

Germany:
 800 1890272
 Other Countries:
 +31 13 5835404

APAC

Shanghai:
 + 86 21 2412 1618/19
 Sydney:
 +61 2 9751 8500



Our powerful portfolio of brands:

CADDY ERICO HOFFMAN ILSCO SCHROFF TRACHTE

