

# D16 Mechanical Anchor for Cryogenic Applications



The nVent LENTON brand of cryogenic reinforcement splicing systems should be specified whenever cryogenic-grade reinforcing bar is used, or during normal operating or emergency conditions where the temperature falls below -20 °C (-4 °F). By combining the nVent LENTON taper-threaded couplers with state-of-the-art materials, we have developed one of the slimmest couplers on the market, while still maintaining top performance. Typical construction projects include LNG and LPG storage tanks.

## FEATURES

Replaces conventional hooked reinforcing bar

Simplifies reinforcing bar placement and lowers placing costs

Head area exceeds 5x bar area (net 4x)

Improved performance and reliability at cryogenic temperatures (-168 °C / -270 °F)

## SPECIFICATIONS

**Finish:** Plain

**Material:** Stainless Steel 431 (EN 1.4057)

Table 1/2

Catalog Number	Rebar Size, Metric	Rebar Size, US	Rebar Size, Canada	Diameter (Ø)	Length (L)	Unit Weight
EL12D16CRN	12 mm	#4	10M	35 mm	19mm	0.13 kg
EL16D16CRN	16 mm	#5	15M	36 mm	24mm	0.16 kg
EL20D16CRN	20 mm	#6	20M	45 mm	35mm	0.37 kg
EL25D16CRN	25 mm	#8	25M	60 mm	40mm	0.77 kg

CatalogNumber	Rebar Size, Metric	Rebar Size, US	Rebar Size, Canada	Diameter (Ø)	Length (L)	Unit Weight
EL28D16CRN	28 mm	#9	30M	65 mm	42mm	0.94 kg
EL32D16CRN	32 mm	#10		75 mm	46mm	1.35 kg

Table 2/2

Catalog Number	Package Quantity
EL12D16CRN	140
EL16D16CRN	100
EL20D16CRN	40
EL25D16CRN	20
EL28D16CRN	15
EL32D16CRN	12

**Designed to Meet:** ACI 318;AS3600;ASTM A970;EN 14620-3

## ADDITIONAL PRODUCT DETAILS

Bar dimensions and weights listed may vary by region. Coupler sizes not shown may be available by special order. Contact your nVent LENTON representative for more information.

Thread does not need to be flush with end of nVent LENTON Terminator. Thread may be +/- 2 threads from backside of coupler.

## DIAGRAMS

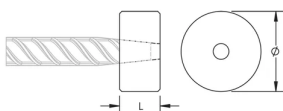

## WARNING

nVent products shall be installed and used only as indicated in nVent's product instruction sheets and training materials. Instruction sheets are available at [www.nvent.com](http://www.nvent.com) and from your nVent customer service representative. Improper

installation, misuse, misapplication or other failure to completely follow nVent's instructions and warnings may cause product malfunction, property damage, serious bodily injury and death and/or void your warranty.

**North America**

+1.800.753.9221  
Option 1 – Customer Care  
Option 2 – Technical  
Support

**Europe**

Netherlands:  
+31 800-0200135  
France:  
+33 800 901 793

**Europe**

Germany:  
800 1890272  
Other Countries:  
+31 13 5835404

**APAC**

Shanghai:  
+ 86 21 2412 1618/19  
Sydney:  
+61 2 9751 8500



Our powerful portfolio of brands:

**CADDY   ERICO   HOFFMAN   ILSCO   SCHROFF   TRACHTE**