

A12 Standard Coupler, Plain, European Design



The European Design Version (Suffix EE) is currently being phased out. All future projects should be designed with the Worldwide Design Version (Suffixes N and LN). This change is being done in order to simplify our product offering and eliminate redundant designs. Please contact Customer Care or your local Sales Engineer/Manager if you require more information on this transition.

CERTIFICATIONS



FEATURES

Designed to splice the same diameter bars where the second bar can be rotated and is not restricted in its axial direction

Slim design maintains concrete cover

Installs quickly and easily

SPECIFICATIONS

Design Version: European (Specialty Materials)

Finish: Plain

Material: Steel

Table 1/2

Catalog Number	Article Number	Rebar Size, Metric	Rebar Size, US	Rebar Size, Canada	Hex Width (W)	Diameter (Ø)
EL12A12EE	150010	12 mm	#4	10M	17 mm	
EL10A12EE	150000	10 mm	#3		17 mm	

CatalogNumber	Article Number	Rebar Size, Metric	Rebar Size, US	Rebar Size, Canada	Hex Width (W)	Diameter (Ø)
EL14A12EE	150020	14 mm			22 mm	
EL16A12EE	150030	16 mm	#5	15M	22 mm	
EL18A12EE	150040	18 mm			27 mm	
EL20A12EE	150050	20 mm	#6	20M	27 mm	
EL25A12EE	150070	25 mm	#8	25M		33 mm
EL28A12EE	150080	28 mm	#9	30M		37 mm
EL30A12EE	150090	30 mm				37 mm
EL36A12EE	150120	36 mm	#11	35M		46 mm
EL32A12EE	150100	32 mm	#10			42 mm
EL40A12EE	150140	40 mm				52 mm
EL38A12EE	150130	38 mm	#12			52 mm
EL34A12EE	150110	34 mm				41 mm
EL43TA12EE	150150	43 mm	#14	45M		58 mm
EL50TA12EE	150160	50 mm				64 mm
EL57TA12EE	150170	57 mm	#18	55M		75 mm

Table 2/2

Catalog Number	Article Number	Length (L)	Bar Depth (BD)	Bar Gap (BG)	Unit Weight	Certifications
EL12A12EE	150010	49mm	18mm	13mm	0.06 kg	AFCAB, KOMO, DIBt

CatalogNumber	Article Number	Length (L)	Bar Depth (BD)	Bar Gap (BG)	Unit Weight	Certifications
EL10A12EE	150000	48mm	18mm	12mm	0.07 kg	AFCAB, DIBt
EL14A12EE	150020	55mm	21mm	13mm	0.13 kg	AFCAB, KOMO, DIBt
EL16A12EE	150030	61mm	24mm	13mm	0.13 kg	AFCAB, KOMO, DIBt
EL18A12EE	150040	71mm	29mm	13mm	0.24 kg	
EL20A12EE	150050	88mm	36mm	16mm	0.27 kg	DIBt, AFCAB, KOMO
EL25A12EE	150070	96mm	41mm	14mm	0.36 kg	DIBt, AFCAB, KOMO
EL28A12EE	150080	101mm	43mm	15mm	0.46 kg	KOMO, DIBt
EL30A12EE	150090	121mm	53mm	15mm	0.51 kg	
EL36A12EE	150120	121mm	53mm	15mm	0.78 kg	
EL32A12EE	150100	107mm	46mm	15mm	0.61 kg	DIBt, KOMO, AFCAB
EL40A12EE	150140	131mm	58mm	15mm	1.13 kg	AFCAB, KOMO, DIBt
EL38A12EE	150130	124mm	54mm	16mm	1.19 kg	
EL34A12EE	150110	128mm	56mm	16mm	0.64 kg	
EL43TA12EE	150150	155mm	68mm	19mm	1.86 kg	
EL50TA12EE	150160	163mm	71mm	21mm	2 kg	
EL57TA12EE	150170	189mm	84mm	21mm	3.39 kg	

Designed to Meet:

AASHTO;ABNT NBR 8548:1984;ACI 318 Type 1 (125% Specified Yield);ACI 318 Type 2 (Specified Tensile);ACI 349;ACI 359;AS3600

ADDITIONAL PRODUCT DETAILS

Bar dimensions and weights listed may vary by region. Coupler sizes not shown may be available by special order. Contact your nVent LENTON representative for more information.

Suffix "EE" has been added to some part numbers to clarify design version among regions.

DIAGRAMS

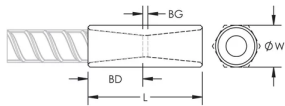

WARNING

nVent products shall be installed and used only as indicated in nVent's product instruction sheets and training materials. Instruction sheets are available at www.nvent.com and from your nVent customer service representative. Improper installation, misuse, misapplication or other failure to completely follow nVent's instructions and warnings may cause product malfunction, property damage, serious bodily injury and death and/or void your warranty.

North America

+1.800.753.9221
Option 1 – Customer Care
Option 2 – Technical
Support

Europe

Netherlands:
+31 800-0200135
France:
+33 800 901 793

Europe

Germany:
800 1890272
Other Countries:
+31 13 5835404

APAC

Shanghai:
+ 86 21 2412 1618/19
Sydney:
+61 2 9751 8500



Our powerful portfolio of brands:

CADDY ERICO HOFFMAN ILSCO SCHROFF TRACHTE