

# Rebar Bonding Clamp



## FEATURES

Provides bond from lightning protection system to rebar

## SPECIFICATIONS

Table 1/2

Catalog Number	Material	Conductor Size, UL	Rebar Size, Canada	Rebar Size, Metric	Rebar Size, US	Depth (D)
LPC466	Brass	Class 2 (4/0 Max)	10M Max	29 mm Max	#9 Max	31.7mm

Table 2/2

Catalog Number	Width (W)	Unit Weight
LPC466	63.5 mm	0.28 kg

## DIAGRAMS

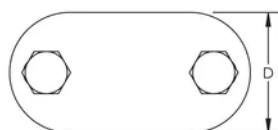
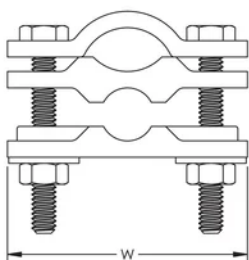

**WARNING**

nVent products shall be installed and used only as indicated in nVent's product instruction sheets and training materials. Instruction sheets are available at [www.nvent.com](http://www.nvent.com) and from your nVent customer service representative. Improper installation, misuse, misapplication or other failure to completely follow nVent's instructions and warnings may cause product malfunction, property damage, serious bodily injury and death and/or void your warranty.

**North America**

+1.800.753.9221  
Option 1 – Customer Care  
Option 2 – Technical  
Support

**Europe**

Netherlands:  
+31 800-0200135  
France:  
+33 800 901 793

**Europe**

Germany:  
800 1890272  
Other Countries:  
+31 13 5835404

**APAC**

Shanghai:  
+ 86 21 2412 1618/19  
Sydney:  
+61 2 9751 8500



Our powerful portfolio of brands:

**CADDY   ERICO   HOFFMAN   ILSCO   SCHROFF   TRACHTE**