

# C12 Weldable Half Coupler



## CERTIFICATIONS



## FEATURES

Designed for connecting reinforcing bar perpendicular to structural steel sections or plates

Internally taper threaded on one end, with the other end prepared for welding

Machined from weldable grades of steel

## SPECIFICATIONS

**Finish:** Plain

**Material:** Steel

Table 1/2

Catalog Number	Article Number	Rebar Size, Metric	Rebar Size, US	Rebar Size, Canada	Diameter 1 (Ø1)	Diameter 2 (Ø2)
EL12C12EE	151090	12 mm	#4	10M	20 mm	12 mm
EL10C12EE	151080	10 mm	#3		20 mm	12 mm
EL16C12EE	151110	16 mm	#5	15M	25 mm	15 mm

CatalogNumber	Article Number	Rebar Size, Metric	Rebar Size, US	Rebar Size, Canada	Diameter 1(Ø1)	Diameter 2(Ø2)
EL14C12EE	151100	14 mm			25 mm	13 mm
EL18C12EE	151120	18 mm			30 mm	16 mm
EL20C12EE	151130	20 mm	#6	20M	30 mm	17 mm
EL28C12EE	151160	28 mm	#9	30M	40 mm	24 mm
EL25C12EE	151150	25 mm	#8	25M	40 mm	21 mm
EL22C12EE	151140	22 mm	#7		40 mm	18 mm
EL32C12EE	151180	32 mm	#10		50 mm	28 mm
EL34C12EE	151190	34 mm			50 mm	28 mm
EL30C12EE	151170	30 mm			50 mm	24 mm
EL36C12EE	151200	36 mm	#11	35M	60 mm	31 mm
EL38C12EE	151210	38 mm	#12		60 mm	33 mm
EL40C12EE	151220	40 mm			60 mm	34 mm
EL43TC12EE	151230	43 mm	#14	45M	75 mm	36 mm
EL50TC12EE	151240	50 mm			75 mm	43 mm

Table 2/2

Catalog Number	Article Number	Length (L)	Bar Depth (BD)	Unit Weight	Package Quantity	Certifications
EL12C12EE	151090	30mm	18mm	0.05 kg	500	DIBt, AFCAB
EL10C12EE	151080	30mm	18mm	0.06 kg	555	DIBt, AFCAB

CatalogNumber	Article Number	Length (L)	Bar Depth (BD)	Unit Weight	Package Quantity	Certifications
EL16C12EE	151110	40mm	24mm	0.09 kg	250	DIBt, AFCAB
EL14C12EE	151100	35mm	21mm	0.09 kg	290	AFCAB, DIBt
EL18C12EE	151120	45mm	29mm	0.16 kg	155	
EL20C12EE	151130	50mm	36mm	0.17 kg	150	AFCAB, DIBt
EL28C12EE	151160	55mm	43mm	0.29 kg	70	DIBt
EL25C12EE	151150	55mm	41mm	0.32 kg	80	AFCAB, DIBt
EL22C12EE	151140	55mm	38mm	0.35 kg	72	
EL32C12EE	151180	60mm	46mm	0.52 kg	45	AFCAB, DIBt
EL34C12EE	151190	70mm	56mm	0.6 kg	35	
EL30C12EE	151170	65mm	53mm	0.6 kg	40	
EL36C12EE	151200	65mm	53mm	0.83 kg	25	
EL38C12EE	151210	70mm	54mm	0.89 kg	5	
EL40C12EE	151220	75mm	58mm	0.92 kg	25	AFCAB, DIBt
EL43TC12EE	151230	85mm	68mm	1.26 kg	5	
EL50TC12EE	151240	90mm	71mm	1.73 kg	10	

## ADDITIONAL PRODUCT DETAILS

Bar dimensions and weights listed may vary by region. Coupler sizes not shown may be available by special order. Contact your nVent LENTON representative for more information.

The design of the weld, the selection of electrode, and other relevant choices depend on the chemical and physical properties of the structural steel to which the couplers are welded. Engineers who design assemblies should adhere to all

appropriate regulations.

Suffix "EE" has been added to some part numbers to clarify design version among regions.

DIAGRAMS

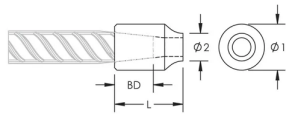

WARNING

nVent products shall be installed and used only as indicated in nVent's product instruction sheets and training materials. Instruction sheets are available at [www.nvent.com](http://www.nvent.com) and from your nVent customer service representative. Improper installation, misuse, misapplication or other failure to completely follow nVent's instructions and warnings may cause product malfunction, property damage, serious bodily injury and death and/or void your warranty.

North America

+1.800.753.9221  
Option 1 – Customer Care  
Option 2 – Technical  
Support

Europe

Netherlands:  
+31 800-0200135  
France:  
+33 800 901 793

Europe

Germany:  
800 1890272  
Other Countries:  
+31 13 5835404

APAC

Shanghai:  
+ 86 21 2412 1618/19  
Sydney:  
+61 2 9751 8500



Our powerful portfolio of brands:

CADDY   ERICO   HOFFMAN   ILSCO   SCHROFF   TRACHTE