

Branch Line Restraint Structure Attachment to Steel

Data Solutions



CERTIFICATIONS



FEATURES

Swivel barrel nut accepts 3/8" or 1/2" (M10 or M12) threaded rod

Attaches to steel members with self-drilling/tapping screw

SPECIFICATIONS

Table 1/2

| Catalog Number | Article Number | Material | Finish | Rod Size (RS) | Flange Thickness (FT) | Height (H) |
|----------------|----------------|----------|-------------------|---------------|-----------------------|------------|
| CSBBRS1MEG | 402239 | Steel | Electrogalvanized | 10, 12 | 2.7 – 12.7mm | 28.2mm |

Table 2/2

| Catalog Number | Article Number | Length (L) | Width (W) | Screw Diameter (Sc) | Screw Length (L) |
|----------------|----------------|------------|-----------|---------------------|------------------|
|----------------|----------------|------------|-----------|---------------------|------------------|

| | | | | | |
|------------|--------|--------|--------|-------|------|
| CSBBRS1MEG | 402239 | 40.4mm | 26.9mm | 2.7mm | 32mm |
|------------|--------|--------|--------|-------|------|

ADDITIONAL PRODUCT DETAILS

Branch line structural attachments are for restraint only and not for the hanging of fire sprinkler piping.

DIAGRAMS

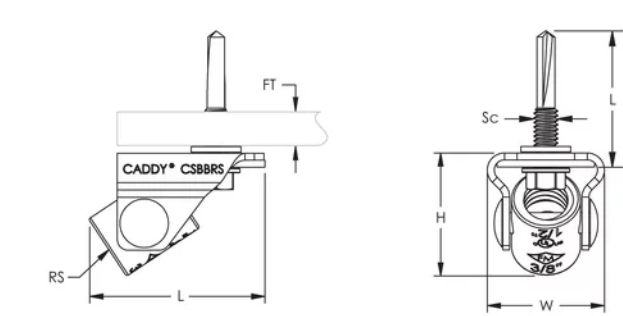

WARNING

nVent products shall be installed and used only as indicated in nVent's product instruction sheets and training materials. Instruction sheets are available at www.nvent.com and from your nVent customer service representative. Improper installation, misuse, misapplication or other failure to completely follow nVent's instructions and warnings may cause product malfunction, property damage, serious bodily injury and death and/or void your warranty.



Our powerful portfolio of brands:

CADDY ERICO HOFFMAN ILSCO SCHROFF TRACHTE