

# Right Angle Extension Adaptor



## CERTIFICATIONS



## FEATURES

Provides an additional 2" (50.8 mm) offset when used with air terminal bases

Can be coupled with Imperial Adaptors to provide a total of 3" (76.2 mm) offset

## SPECIFICATIONS

Table 1/1

Catalog Number	Material	Thread Size 1 (TS1)	Thread Size 2 (TS2)	Length (L)	Diameter (Ø)	Unit Weight
LPC29612	Copper	1/2" UNC	1/2" UNC	68.26mm	23.81 mm	0.08 kg

DIAGRAMS

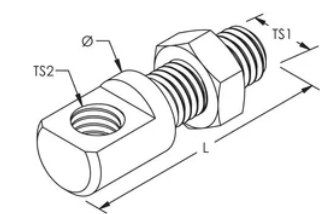

WARNING

nVent products shall be installed and used only as indicated in nVent's product instruction sheets and training materials. Instruction sheets are available at [www.nvent.com](http://www.nvent.com) and from your nVent customer service representative. Improper installation, misuse, misapplication or other failure to completely follow nVent's instructions and warnings may cause product malfunction, property damage, serious bodily injury and death and/or void your warranty.

⚠ WARNING: This product can expose you to chemicals including lead, which is known to the State of California to cause cancer and birth defects or other reproductive harm. For more information go to [www.P65Warnings.ca.gov](http://www.P65Warnings.ca.gov).

North America

+1.800.753.9221  
Option 1 – Customer Care  
Option 2 – Technical  
Support

Europe

Netherlands:  
+31 800-0200135  
France:  
+33 800 901 793

Europe

Germany:  
800 1890272  
Other Countries:  
+31 13 5835404

APAC

Shanghai:  
+ 86 21 2412 1618/19  
Sydney:  
+61 2 9751 8500



Our powerful portfolio of brands:

CADDY   ERICO   HOFFMAN   ILSCO   SCHROFF   TRACHTE