

Sealing Disk



Sealing disks are typically used in vertical pump fill applications, such as columns and shear walls. The sealing disk prevents bedding mortar from entering into the sleeve during installation and grout filling.

FEATURES

Rubber seal is designed to fit tightly around the reinforcing bar

Easy to install

SPECIFICATIONS

Material: Steel;Neoprene

Table 1/2

| Catalog Number | Article Number | Rebar Size, Metric | Rebar Size, US | Rebar Size, Canada | Diameter 1 (Ø1) | Diameter 2 (Ø2) |
|----------------|----------------|--------------------|----------------|--------------------|-----------------|-----------------|
| LK607 | 145640 | 16 mm, 20 mm | #5, #6, #7 | 15M, 20M | 89 mm | 12.7 mm |
| LK608 | 145645 | 25 mm | #8 | 25M | 92 mm | 22.2 mm |
| LK609 | 145650 | 28 mm | #9 | 30M | 95 mm | 25.4 mm |
| LK610 | 145655 | 32 mm | #10 | | 102 mm | 28.6 mm |
| LK611 | 145660 | 36 mm | #11 | 35M | 105 mm | 28.6 mm |
| LK614 | 145665 | 43 mm | #14 | 45M | 105 mm | 38.1 mm |

Table 2/2

| Catalog Number | Article Number | Thickness (T) | Unit Weight |
|----------------|----------------|---------------|-------------|
| LK607 | 145640 | 2 mm | 0.03 kg |
| LK608 | 145645 | 2 mm | 0.03 kg |
| LK609 | 145650 | 2 mm | 0.04 kg |
| LK610 | 145655 | 2 mm | 0.04 kg |
| LK611 | 145660 | 2 mm | 0.04 kg |
| LK614 | 145665 | 2 mm | 0.04 kg |

ADDITIONAL PRODUCT DETAILS

Prior to installation, please read and understand the detailed instructions and safety notices provided in the nVent LENTON Interlok Instruction Manual.

DIAGRAMS

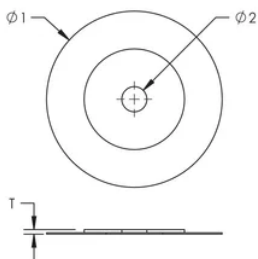

WARNING

nVent products shall be installed and used only as indicated in nVent's product instruction sheets and training materials. Instruction sheets are available at www.nvent.com and from your nVent customer service representative. Improper installation, misuse, misapplication or other failure to completely follow nVent's instructions and warnings may cause product malfunction, property damage, serious bodily injury and death and/or void your warranty.

North America

+1.800.753.9221

Option 1 – Customer Care

Option 2 – Technical

Support

Europe

Netherlands:

+31 800-0200135

France:

+33 800 901 793

Europe

Germany:

800 1890272

Other Countries:

+31 13 5835404

APAC

Shanghai:

+ 86 21 2412 1618/19

Sydney:

+61 2 9751 8500



Our powerful portfolio of brands:

CADDY

ERICO

HOFFMAN

ILSCO

SCHROFF

TRACHTE