

PM04 Hybrid Position Coupler



The nVent LENTON Ultimate PM04 Hybrid Position Coupler is used in conjunction with LENTON taper-threaded rebar, that is produced on standard LENTON threading equipment globally.

LENTON Ultimate platform utilizes a high efficiency parallel thread that provides “full strength” in tension, compression and stress reversal applications, while also providing positional adjustability. The nVent LENTON self-aligning taper-thread reduces misalignment issues, and helps eliminate cross-threading during installation.

Typical applications include bent bar, prefabricated cages and precast structural elements.

CERTIFICATIONS



FEATURES

Slim design maintains concrete cover

Installs quickly and easily

Utilizes the standard nVent LENTON taper profile

Designed to splice the same diameter bars

Designed to splice two curved, bent or straight bars, when neither bar can be rotated and where the ongoing bar is free to move in its axial direction

SPECIFICATIONS

Finish:	Plain
Coupler Adjustment:	Standard
Material:	Steel

Table 1/2

Catalog Number	Rebar Size, Metric	Rebar Size, US	Rebar Size, Canada	Hex Width 1 (W1)	Hex Width 2 (W2)	Diameter 1 (Ø1)
----------------	--------------------	----------------	--------------------	------------------	------------------	-----------------

LU16PM04	16 mm	#5	15M	22 mm	27 mm	
LU20PM04	20 mm	#6	20M	27 mm		
LU25PM04	25 mm	#8	25M	30 mm		
LU32PM04	32 mm	#10				36 mm
LU40PM04	40 mm					45 mm

Table 2/2

Catalog Number	Diameter 2 (Ø2)	Coupler Body (CB)	Bar Depth (BD)	Thread Size (TS)	Unit Weight
LU16PM04		49mm	24mm	M18	0.28 kg
LU20PM04	36 mm	68mm	35mm	M24	0.58 kg
LU25PM04	38 mm	77mm	40mm	M29	0.77 kg
LU32PM04	51 mm	88mm	45mm	M36	1.34 kg
LU40PM04	60 mm	106mm	57mm	M44	2.26 kg

Designed to Meet: AASHTO;ABNT NBR 8548:1984;ACI 318 Type 1 (125% Specified Yield);ACI 318 Type 2 (Specified Tensile);ACI 349;ACI 359;AS3600

ADDITIONAL PRODUCT DETAILS

Bar dimensions and weights listed may vary by region. Coupler sizes not shown may be available by special order. Contact your nVent LENTON representative for more information.

DIAGRAMS

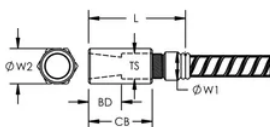

WARNING

nVent products shall be installed and used only as indicated in nVent's product instruction sheets and training materials. Instruction sheets are available at www.nvent.com and from your nVent customer service representative. Improper installation, misuse, misapplication or other failure to completely follow nVent's instructions and warnings may cause product malfunction, property damage, serious bodily injury and death and/or void your warranty.

North America

+1.800.753.9221
Option 1 – Customer Care
Option 2 – Technical
Support

Europe

Netherlands:
+31 800-0200135
France:
+33 800 901 793

Europe

Germany:
800 1890272
Other Countries:
+31 13 5835404

APAC

Shanghai:
+ 86 21 2412 1618/19
Sydney:
+61 2 9751 8500



Our powerful portfolio of brands:

CADDY ERICO HOFFMAN ILSCO SCHROFF TRACHTE