

# nVent LENTON Quick Wedge Mechanical Lap Coupler, Plain, Pin Included



The nVent LENTON Quick Wedge splice consists of an oval-shaped steel sleeve and a wedge pin. The sleeve is positioned around two very short overlapping steel bars. The wedge pin is inserted into a handheld hydraulic pin-driver and positioned on the sleeve. The pin is then driven through the pre-drilled hole in the sleeve and between the bars to complete the connection.

## FEATURES

Short reinforcing bar overlap significantly reduces concrete removal in retrofit applications

Eliminates the need to custom cut and fit rebar to precise measurements

Quick installations result in accelerated job scheduling

Simple to use with only minimal training required

Splice offers quick visual inspection

Each package contains couplers, wedge pins and a spare grommet

## SPECIFICATIONS

**Finish:** Plain  
**Packaging:** Standard  
**Material:** Steel

Table 1/2

Catalog Number	Article Number	Rebar Size, Metric	Rebar Size, US	Rebar Size, Canada	Length (L)	Width (W)
ML12MM	145700	12 mm			48mm	40 mm
ML5	145710	16 mm	#5	15M	57mm	49 mm
ML20MM	145720	20 mm			70mm	59 mm

Table 2/2

Catalog Number	Article Number	Height (H)	Unit Weight	Package Quantity
ML12MM	145700	27 mm	0.23 kg	25
ML5	145710	33 mm	0.36 kg	25
ML20MM	145720	40 mm	0.54 kg	25

**Designed to Meet:** AASHTO;ACI 318 Type 1 (125% Specified Yield)

## ADDITIONAL PRODUCT DETAILS

Prior to installation, please read and understand the detailed instructions and safety notices provided in the nVent LENTON Quick Wedge Operator's Manual.

## DIAGRAMS

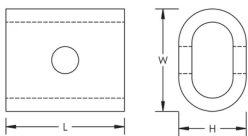

## WARNING

nVent products shall be installed and used only as indicated in nVent's product instruction sheets and training materials. Instruction sheets are available at [www.nvent.com](http://www.nvent.com) and from your nVent customer service representative. Improper installation, misuse, misapplication or other failure to completely follow nVent's instructions and warnings may cause product malfunction, property damage, serious bodily injury and death and/or void your warranty.

### North America

+1.800.753.9221  
Option 1 – Customer Care  
Option 2 – Technical  
Support

### Europe

Netherlands:  
+31 800-0200135  
France:  
+33 800 901 793

### Europe

Germany:  
800 1890272  
Other Countries:  
+31 13 5835404

### APAC

Shanghai:  
+ 86 21 2412 1618/19  
Sydney:  
+61 2 9751 8500



Our powerful portfolio of brands:

**CADDY ERICO HOFFMAN ILSCO SCHROFF TRACHTE**