

2 Hole Lug

Data Solutions



FEATURES

Provides an efficient bolting surface for grounding and power applications

Electrolytic grade copper

For use with nVent ERICO Cadweld type LA connections only

SPECIFICATIONS

Material: Copper

Type: NEMA®

Finish: Tinned

Table 1/2

Catalog Number	Length (L)	Width (W)	Thickness (T)	A	B	Hole Size (HS)
B103CE002	88.9mm	25.4mm	3.18mm	15.9mm	44.45mm	11.11mm
B102CE	101.6mm	25.4mm	3.18mm	15.9mm	44.45mm	14.29mm
B102DE	101.6mm	25.4mm	4.76mm	15.9mm	44.45mm	14.29mm
B102EG	104.78mm	38.1mm	6.35mm	15.9mm	44.45mm	14.29mm

CatalogNumber	Length (L)	Width (W)	Thickness (T)	A	B	Hole Size (HS)
B102EH001	152.4mm	50.8mm	6.35mm	15.9mm	44.45mm	14.29mm
B103EK004	76.2mm	76.2mm	6.35mm	25.4mm	44.45mm	14.29mm
B102EE	104.78mm	25.4mm	6.35mm	15.9mm	44.45mm	14.29mm
B102EH	104.78mm	50.8mm	6.35mm	15.9mm	44.45mm	14.29mm
B102GG	120.65mm	38.1mm	9.53mm	15.9mm	44.45mm	14.29mm
B102GH	120.65mm	50.8mm	9.53mm	15.9mm	44.45mm	14.29mm
B102JH	133.35mm	50.8mm	12.7mm	15.9mm	44.45mm	14.29mm

Table 2/2

Catalog Number	Equivalent Conductor Size
B103CE002	80.63mm ²
B102CE	80.63mm ²
B102DE	120.94mm ²
B102EG	242mm ²
B102EH001	322.51mm ²
B103EK004	483.77mm ²
B102EE	161.26mm ²
B102EH	322.51mm ²
B102GG	362.83mm ²
B102GH	483.77mm ²

Catalog Number	Equivalent Conductor Size
B102JH	645.03mm ²

ADDITIONAL PRODUCT DETAILS

For sizes not listed, contact us.

DIAGRAMS

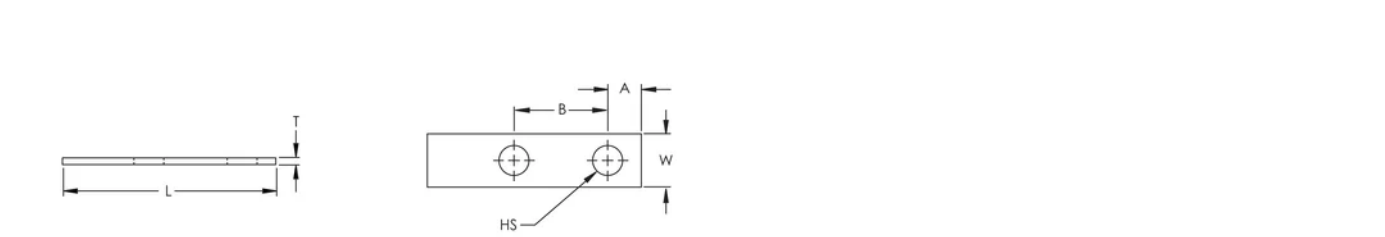

WARNING

nVent products shall be installed and used only as indicated in nVent's product instruction sheets and training materials. Instruction sheets are available at www.nvent.com and from your nVent customer service representative. Improper installation, misuse, misapplication or other failure to completely follow nVent's instructions and warnings may cause product malfunction, property damage, serious bodily injury and death and/or void your warranty.



Our powerful portfolio of brands:

CADDY ERICO HOFFMAN ILSCO SCHROFF TRACHTE