

115 Standard Duty Loop Hanger



The 115 Standard Duty Loop Hanger is ideal for suspending stationary, non-insulated pipe lines, including CPVC pipes, in fire sprinkler systems. A knurled insert nut helps simplify vertical adjustments and flared edges on the base (1/2" to 4" sizes) help protect pipes from coming into contact with any sharp edges of the hanger.

CERTIFICATIONS



FEATURES

Flared edges help prevent any sharp surfaces from coming into contact with the pipe (1/2" to 4" sizes)

Retained insert nut helps ensure the loop hanger and insert nut stay together

Recommended for the suspension of stationary non-insulated pipe lines

Manufactured to use the minimum rod size permitted by NFPA® for fire sprinkler piping

Conforms with Federal Specification WW-H-171 (Type 10), Manufacturers Standardization Society (MSS) SP-58 (Type 10)

SPECIFICATIONS

Finish: Pregalvanized

Material: Steel

Table 1/2

Catalog Number	Article Number	NB/DN	Outer Diameter (OD)	A	B	C
1150250EG	182798	65	76 mm	150.8 mm	87.3 mm	50.8 mm
1150300EG	182804	80	89 mm	166.3 mm	88.2 mm	49.7 mm

CatalogNumber	Article Number	NB/DN	Outer Diameter (OD)	A	B	C
1150400EG	182805	100	114 mm	192.5 mm	100.9 mm	48.9 mm
1150500EG	182799	125	140 mm	232.7 mm	120 mm	57.1 mm
1150600EG	182806	150	165 mm	286.6 mm	160.4 mm	84.1 mm
1150800EG		200	219 mm	327.1 mm	175.1 mm	73.4 mm

Table 2/2

Catalog Number	Article Number	Static Load
1150250EG	182798	2340N
1150300EG	182804	2340N
1150400EG	182805	2890N
1150500EG	182799	4450N
1150600EG	182806	4450N
1150800EG		4450N

DIAGRAMS

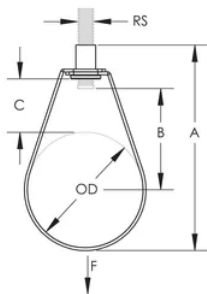

WARNING

nVent products shall be installed and used only as indicated in nVent's product instruction sheets and training materials. Instruction sheets are available at www.nvent.com and from your nVent customer service representative. Improper installation, misuse, misapplication or other failure to completely follow nVent's instructions and warnings may cause product malfunction, property damage, serious bodily injury and death and/or void your warranty.

North America

+1.800.753.9221

Option 1 – Customer Care

Option 2 – Technical

Support

Europe

Netherlands:

+31 800-0200135

France:

+33 800 901 793

Europe

Germany:

800 1890272

Other Countries:

+31 13 5835404

APAC

Shanghai:

+ 86 21 2412 1618/19

Sydney:

+61 2 9751 8500



Our powerful portfolio of brands:

CADDY

ERICO

HOFFMAN

ILSCO

SCHROFF

TRACHTE

