

Branch Line Restraint Structure Attachment to Steel

Data Solutions



CERTIFICATIONS



FEATURES

Swivel barrel nut accepts 3/8" or 1/2" (M10 or M12) threaded rod

Attaches to steel members with self-drilling/tapping screw

SPECIFICATIONS

Table 1/2

Catalog Number	Article Number	Material	Finish	Rod Size (RS)	Flange Thickness (FT)	Height (H)
CSBBRS1MEG	402239	Steel	Electrogalvanized	10, 12	2.7 – 12.7mm	28.2mm

Table 2/2

Catalog Number	Article Number	Length (L)	Width (W)	Screw Diameter (Sc)	Screw Length (L)
----------------	----------------	------------	-----------	---------------------	------------------

CSBBRS1MEG	402239	40.4mm	26.9mm	2.7mm	32mm
------------	--------	--------	--------	-------	------

ADDITIONAL PRODUCT DETAILS

Branch line structural attachments are for restraint only and not for the hanging of fire sprinkler piping.

DIAGRAMS

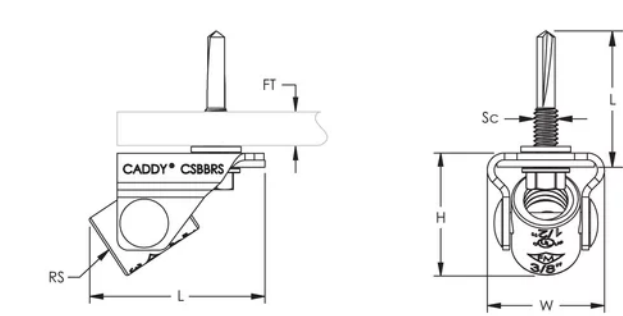

WARNING

nVent products shall be installed and used only as indicated in nVent's product instruction sheets and training materials. Instruction sheets are available at www.nvent.com and from your nVent customer service representative. Improper installation, misuse, misapplication or other failure to completely follow nVent's instructions and warnings may cause product malfunction, property damage, serious bodily injury and death and/or void your warranty.



Our powerful portfolio of brands:

CADDY ERICO HOFFMAN ILSCO SCHROFF TRACHTE