

Insulated Conductor for Wind Turbine Blade Protection

Power Utilities



FEATURES

Insulation cold bend test per UL® 758

SPECIFICATIONS

Working Temperature: -40 to 105 °C

Table 1/1

Catalog Number	Insulation Thickness	Dielectric Strength
LPA103IN	2 mm	20 kV/mm
LPA103IN0100.0	2 mm	20 kV/mm
LPA103IN0500.0	2 mm	20 kV/mm
LPC050IN	2 mm	20 kV/mm
LPC050IN0044.0	2 mm	20 kV/mm

Catalog Number	Insulation Thickness	Dielectric Strength
LPC050IN0047.0	2 mm	20 kV/mm
LPC050IN0100.0	2 mm	20 kV/mm
LPC103IN	2 mm	20 kV/mm

ADDITIONAL PRODUCT DETAILS

LPA103IN, LPC050IN and LPC103IN represent the base part number and are orderable in custom lengths.

DIAGRAMS

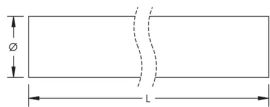

WARNING

nVent products shall be installed and used only as indicated in nVent's product instruction sheets and training materials. Instruction sheets are available at www.nvent.com and from your nVent customer service representative. Improper installation, misuse, misapplication or other failure to completely follow nVent's instructions and warnings may cause product malfunction, property damage, serious bodily injury and death and/or void your warranty.

⚠ WARNING: This product can expose you to chemicals including vinyl chloride, which is known to the State of California to cause cancer. For more information go to www.P65Warnings.ca.gov.



Our powerful portfolio of brands:

CADDY ERICO HOFFMAN ILSCO SCHROFF TRACHTE