

Deck Assembly



Deck assemblies hold the nVent LENTON Quick Wedge coupler in place during installation. The Deck Assemblies attach to the yoke of the pin driver. Each deck assembly is designed for a specific reinforcing bar size and is quickly and easily changed in the field.

FEATURES

Color-coded and stamped with appropriate reinforcing bar size

Simple design allows quick changes between bar sizes

Securely holds the coupler during assembly

SPECIFICATIONS

Finish: Painted

Material: Steel

Table 1/2

| Catalog Number | Article Number | Rebar Size, Metric | Rebar Size, US | Rebar Size, Canada | Length (L) | Width (W) |
|----------------|----------------|--------------------|----------------|--------------------|------------|-----------|
| ML534 | 145792 | 20 mm | #6 | 20M | 102mm | 88 mm |
| ML533 | 145791 | 16 mm | #5 | 15M | 102mm | 88 mm |
| ML532 | 145790 | 12 mm | #4 | 10M | 102mm | 88 mm |

Table 2/2

| Catalog Number | Article Number | Height (H) | Unit Weight | Color |
|----------------|----------------|------------|-------------|--------|
| ML534 | 145792 | 93 mm | 0.48 kg | Yellow |

| Catalog Number | Article Number | Height (H) | Unit Weight | Color |
|----------------|----------------|------------|-------------|--------|
| ML533 | 145791 | 93 mm | 0.64 kg | Orange |
| ML532 | 145790 | 93 mm | 0.71 kg | Red |

ADDITIONAL PRODUCT DETAILS

Prior to installation, please read and understand the detailed instructions and safety notices provided in the nVent LENTON Quick Wedge Operator's Manual.

DIAGRAMS

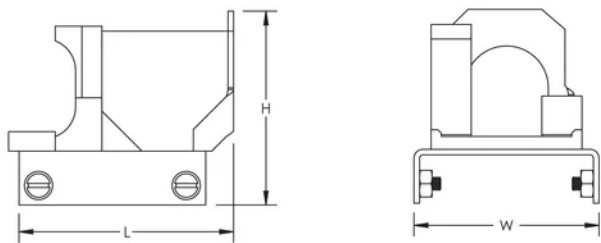

WARNING

nVent products shall be installed and used only as indicated in nVent's product instruction sheets and training materials. Instruction sheets are available at www.nvent.com and from your nVent customer service representative. Improper installation, misuse, misapplication or other failure to completely follow nVent's instructions and warnings may cause product malfunction, property damage, serious bodily injury and death and/or void your warranty.

North America

+1.800.753.9221
Option 1 – Customer Care
Option 2 – Technical
Support

Europe

Netherlands:
+31 800-0200135
France:
+33 800 901 793

Europe

Germany:
800 1890272
Other Countries:
+31 13 5835404

APAC

Shanghai:
+ 86 21 2412 1618/19
Sydney:
+61 2 9751 8500



Our powerful portfolio of brands:

CADDY ERICO HOFFMAN ILSCO SCHROFF TRACHTE