

Rail Bootleg Bond Kit, Tab Style



The nVent ERICO Cadweld bootleg bonds are intended to be welded to the web of the rail at the rail profile neutral axis level. To ensure connection integrity, the attachment shall be made using nVent ERICO Cadweld welding material.

FEATURES

Offers broken rail protection and significant corrosion resistance

Provides unchanging electrical resistance

Two versions of Bond Terminal Styles available

Easy installation, with minimum installer training required

Simple and highly-portable installation equipment

Equally usable on old, worn, or new rails

Highly durable

SPECIFICATIONS

Material: Cadmium Bronze;Copper Alloy

Bond Terminal Style: Tab

Table 1/1

Catalog Number	Finish	Conductor Size	Length 1 (L1)	Length 2 (L2)	Diameter (Ø)
SBTBB3348	Bare, Tinned	3/16" Bondstrand	1219.2 mm	20.64 mm	4.8 mm
SBTBB336	Bare, Tinned	3/16" Bondstrand	152.4 mm	20.64 mm	4.8 mm
SBTBB3412	Bare, Tinned	3/16" Bondstrand	304.8 mm	27 mm	4.8 mm
SBTBB346	Bare, Tinned	3/16" Bondstrand	152.4 mm	27 mm	4.8 mm

Catalog Number	Finish	Conductor Size	Length 1 (L1)	Length 2 (L2)	Diameter (Ø)
SBTBBU412	Tinned	3/16" Bondstrand	304.8 mm	27 mm	4.8 mm
SBTBBS46	Bare, Tinned	5/16" Bondstrand	152.4 mm	25.4 mm	7.9 mm

ADDITIONAL PRODUCT DETAILS

SBTBBU412 includes (100) bonds and (100) F80 alloy welding material. All other kits include (25) bonds and (25) F80 alloy welding material.

DIAGRAMS

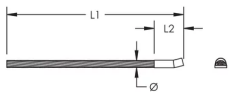

WARNING

nVent products shall be installed and used only as indicated in nVent's product instruction sheets and training materials. Instruction sheets are available at www.nvent.com and from your nVent customer service representative. Improper installation, misuse, misapplication or other failure to completely follow nVent's instructions and warnings may cause product malfunction, property damage, serious bodily injury and death and/or void your warranty.

⚠ WARNING: This product can expose you to chemicals including cadmium, which is known to the State of California to cause birth defects or other reproductive harm. For more information go to www.P65Warnings.ca.gov.

North America

+1.800.753.9221
Option 1 – Customer Care
Option 2 – Technical
Support

Europe

Netherlands:
+31 800-0200135
France:
+33 800 901 793

Europe

Germany:
800 1890272
Other Countries:
+31 13 5835404

APAC

Shanghai:
+ 86 21 2412 1618/19
Sydney:
+61 2 9751 8500



Our powerful portfolio of brands:

CADDY ERICO HOFFMAN ILSCO SCHROFF TRACHTE