

# nVent ERICO PermaGround Cast Beam Bonding Clamp

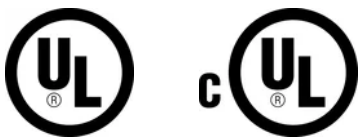

nVent ERICO PermaGround Cast Beam Bonding Clamp is a device used to establish a secure electrical connection between a cable and a flat metal object, like an I-beam or channel iron. It's designed for applications where grounding or bonding of electrical systems is necessary, ensuring the safe flow of electrical current.

## CERTIFICATIONS



## FEATURES

Clamp for bonding cable to flat metal objects such as I-beams, angle irons and channel irons

## SPECIFICATIONS

Table 1/2

Catalog Number	Conductor Size, UL	Material	Finish	Flange Thickness (FT)	Depth (D)	Width (W)
LPA559	Class 1 - Class 2 (4/0 Max)	Aluminum	Bare	6.35 mm Max	57.15mm	40.6 mm
LPC559	Class 1 - Class 2 (4/0 Max)	Copper	Bare	6.35 mm Max	57.15mm	40.6 mm
LPC559L	Class 1 - Class 2 (4/0 Max)	Copper	Tinned	6.35 mm Max	57.15mm	40.6 mm

Table 2/2

Catalog Number	Unit Weight
----------------	-------------

LPA559	0.06 kg
LPC559	0.17 kg
LPC559L	0.17 kg

### DIAGRAMS

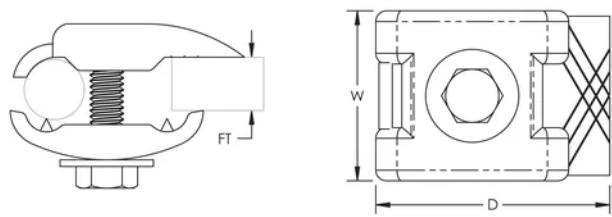

### WARNING

nVent products shall be installed and used only as indicated in nVent's product instruction sheets and training materials. Instruction sheets are available at [www.nvent.com](http://www.nvent.com) and from your nVent customer service representative. Improper installation, misuse, misapplication or other failure to completely follow nVent's instructions and warnings may cause product malfunction, property damage, serious bodily injury and death and/or void your warranty.

#### North America

+1.800.753.9221  
Option 1 – Customer Care  
Option 2 – Technical Support

#### Europe

Netherlands:  
+31 800-0200135  
France:  
+33 800 901 793

#### Europe

Germany:  
800 1890272  
Other Countries:  
+31 13 5835404

#### APAC

Shanghai:  
+ 86 21 2412 1618/19  
Sydney:  
+61 2 9751 8500



Our powerful portfolio of brands:

CADDY   ERICO   HOFFMAN   ILSCO   SCHROFF   TRACHTE