

# Industrial Stack Bonding Lug



## CERTIFICATIONS



## FEATURES

Cast lug for bonding conductors to structural features

## SPECIFICATIONS

**Conductor Size, UL:** Class 1 - Class 2 (4/0 Max)

Table 1/2

Catalog Number	Material	Finish	Hole Size (HS)	Contact Area	Depth (D)	Height (H)
LPS451	Stainless Steel 316L (EN 1.4404)		19.05 mm	19 cm <sup>2</sup> Min	27mm	104.78 mm
LPC451	Brass		19.05 mm	19 cm <sup>2</sup> Min	27mm	104.78 mm
LPLC451	Brass	Lead Covered	19.05 mm	19 cm <sup>2</sup> Min	27mm	104.78 mm

Table 2/2

Catalog Number	Width (W)	Unit Weight	Certifications
LPS451	54 mm	0.28 kg	E202878-Combined_CoC, E202878-Combined_CoC
LPC451	54 mm	0.33 kg	E202878-Combined_CoC, E202878-Combined_CoC
LPLC451	54 mm	0.68 kg	

## ADDITIONAL PRODUCT DETAILS

Where applicable, lead covering thickness is a minimum of 1/16" (1.59 mm) and is not included in the stated dimensions.

## DIAGRAMS

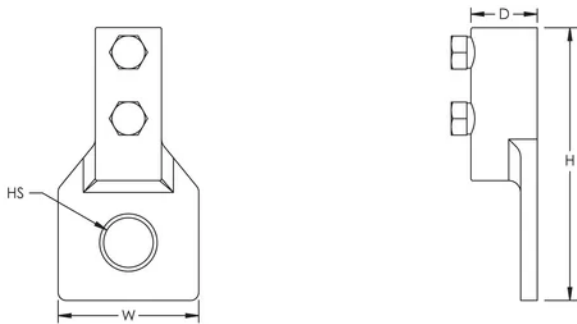

## WARNING

nVent products shall be installed and used only as indicated in nVent's product instruction sheets and training materials. Instruction sheets are available at [www.nvent.com](http://www.nvent.com) and from your nVent customer service representative. Improper installation, misuse, misapplication or other failure to completely follow nVent's instructions and warnings may cause product malfunction, property damage, serious bodily injury and death and/or void your warranty.

⚠ WARNING: This product can expose you to chemicals including lead, which is known to the State of California to cause cancer and birth defects or other reproductive harm. For more information go to [www.P65Warnings.ca.gov](http://www.P65Warnings.ca.gov).

#### North America

+1.800.753.9221

Option 1 – Customer Care

Option 2 – Technical

Support

#### Europe

Netherlands:

+31 800-0200135

France:

+33 800 901 793

#### Europe

Germany:

800 1890272

Other Countries:

+31 13 5835404

#### APAC

Shanghai:

+ 86 21 2412 1618/19

Sydney:

+61 2 9751 8500



Our powerful portfolio of brands:

**CADDY**

**ERICO**

**HOFFMAN**

**ILSCO**

**SCHROFF**

**TRACHTE**