

# Plug Bond, Signal, Copper, Steel, Carbon Steel, EG, Tinned, PG, 0.334" Diameter, 1,168.4 mm

## CATALOG NUMBER

**SBPAJB46**



## FEATURES

Designed for application to the rail web

Hammered into a 3/8" (9.5 mm) diameter hole drilled through the rail web and driven from the same side the hole was drilled

Recommended method of installation requires a bond 12" (304.8 mm) longer than the splice bar

## PRODUCT ATTRIBUTES

Material: Copper;Steel;Carbon Steel

Finish: Electrogalvanized;Tinned;Pregalvanized

Conductor Size: 0.334" Diameter

Length (L): 1168.4mm

Diameter 1 (Ø1): 8.5 mm

Diameter 2 (Ø2): 10.5 mm

Depth (D): 31 3/4mm

## ADDITIONAL PRODUCT DETAILS

Plug Bond Grease (T369) recommended when installing.

DIAGRAMS

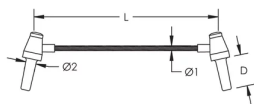

WARNING

nVent products shall be installed and used only as indicated in nVent's product instruction sheets and training materials. Instruction sheets are available at [www.nvent.com](http://www.nvent.com) and from your nVent customer service representative. Improper installation, misuse, misapplication or other failure to completely follow nVent's instructions and warnings may cause product malfunction, property damage, serious bodily injury and death and/or void your warranty.

North America

+1.800.753.9221  
Option 1 – Customer Care  
Option 2 – Technical  
Support

Europe

Netherlands:  
+31 800-0200135  
France:  
+33 800 901 793

Europe

Germany:  
800 1890272  
Other Countries:  
+31 13 5835404

APAC

Shanghai:  
+ 86 21 2412 1618/19  
Sydney:  
+61 2 9751 8500



Our powerful portfolio of brands:

CADDY   ERICO   HOFFMAN   ILSCO   SCHROFF   TRACHTE