

# WBT Performance Cable Tray Double Splice



The nVent CADDY WBT Performance Cable Tray Double Splice facilitates the joining of wire basket trays together. Designed for tray depths of four inches deep and greater, the Double Splice reduces the total number of splices required to secure a cable tray. Simply slide the large washer along the inside of the tray, attach the long washer from the outside and secure the connection by screwing on the nut. Contractors can depend on the Double Splice for a secure and safe solution for datacom-based applications.

## CERTIFICATIONS



## FEATURES

Easy-to-use, requiring only simple hand tools to install

Three-piece bolt, washer and nut combination

Ensures a stable and tight fit between tray sections

Works with a wide range of tray sizes and configurations

## SPECIFICATIONS

**Finish:** Electrogalvanized

**Material:** Steel

Table 1/1

Catalog Number	Color	Height (H)	Width (W)	Length (L)	Unit Weight
WBTDLSPLICEWH	White	62.586 mm	30.582 mm	27.2mm	0.073 kg
WBTDLSPLICEBA	Black	62.586 mm	30.582 mm	27.2mm	0.073 kg

DIAGRAMS

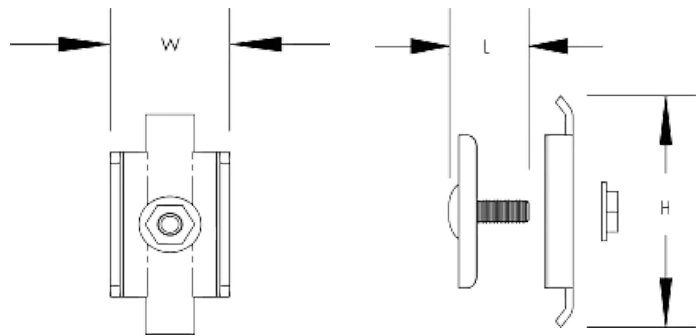

WARNING

nVent products shall be installed and used only as indicated in nVent's product instruction sheets and training materials. Instruction sheets are available at [www.nvent.com](http://www.nvent.com) and from your nVent customer service representative. Improper installation, misuse, misapplication or other failure to completely follow nVent's instructions and warnings may cause product malfunction, property damage, serious bodily injury and death and/or void your warranty.

North America

+1.800.753.9221  
Option 1 – Customer Care  
Option 2 – Technical  
Support

Europe

Netherlands:  
+31 800-0200135  
France:  
+33 800 901 793

Europe

Germany:  
800 1890272  
Other Countries:  
+31 13 5835404

APAC

Shanghai:  
+ 86 21 2412 1618/19  
Sydney:  
+61 2 9751 8500



Our powerful portfolio of brands:

CADDY   ERICO   HOFFMAN   ILSCO   SCHROFF   TRACHTE

