

# Assembly Tool for Front Panel Stainless Steel EMC Gasket

## Power Utilities

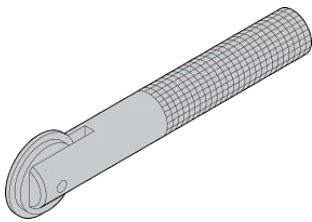

Assembly tool, for mounting the stainless steel EMC gaskets to a front panel.

### CERTIFICATIONS



### FEATURES

Mounting tool for EMC gasketing (stainless steel)

### SPECIFICATIONS

Table 1/1	
Catalog Number	Works With
24560-270	Subracks, Cases

### ADDITIONAL PRODUCT DETAILS

Assembly tool to insert keying/coding pegs in guide rails is available on request.

## WARNING

---

nVent products shall be installed and used only as indicated in nVent's product instruction sheets and training materials. Instruction sheets are available at [www.nvent.com](http://www.nvent.com) and from your nVent customer service representative. Improper installation, misuse, misapplication or other failure to completely follow nVent's instructions and warnings may cause product malfunction, property damage, serious bodily injury and death and/or void your warranty.



Our powerful portfolio of brands:

**CADDY   ERICO   HOFFMAN   ILSCO   SCHROFF   TRACHTE**