

# Quick Grip Lateral Sway Brace

## Data Solutions



The Quick Grip Lateral Brace, part of the nVent CADDY line of fire sprinkler bracing systems from nVent, is designed to help simplify installations when bracing service pipe for seismic or other catastrophic events. It features an innovative design for quick attachment of brace pipe to service pipe saving time and money.

### CERTIFICATIONS



### FEATURES

Easy two-step installation eliminates extra trips between structure and service pipe

Works with 1" and 1 1/4" (25 mm and 32 mm) brace pipes to reduce inventory

Yellow tips provide a visual indicator that the bolts have been properly torqued

Easy installation with an impact wrench from the bottom side of the clamp

Meets NFPA®-13 requirements for seismic sway bracing

Meets CEN/TS 17551:2021 requirements for Seismic Sway Bracing

### SPECIFICATIONS

**Finish:** Electrogalvanized

**Material:** Steel

Table 1/1

Catalog Number	Article Number	NB/DN	Height (H)	Width (W)	Certifications
----------------	----------------	-------	------------	-----------	----------------

CSBQG0250MEG	404475	65	138.1 – 148.6mm	172mm	FM Approved, Seismic, AON Fire Protection, Rigid Seismic
CSBQG0300EG	404469	80	155 – 165.5mm	190mm	OSHDP, cUL, UL, FM Approved, Seismic, AON Fire Protection, Rigid Seismic
CSBQG0400EG	404470	100	180.4 – 190.9mm	222mm	OSHDP/HCAI, AON Fire Protection, Rigid Seismic, cUL, UL, FM Approved, Seismic
CSBQG0600EG	404472	150	235.5 – 244.9mm	298mm	OSHDP, cUL, UL, FM Approved, Seismic, AON Fire Protection, Rigid Seismic
CSBQG0800EG	404473	200	289.2 – 300mm	351.8mm	cUL, UL, FM Approved, Seismic, OSHDP/HCAI, AON Fire Protection, Rigid Seismic

UL Loads				
Part Number	Lateral			
	Sch 10/Sch 40 Service Pipe	Bull Moose Eddy Flow Service Pipe	Wheatland Mega-Flow Service Pipe	Youngstown Fire-Flo Service Pipe
CSBQG0250	6672 N	6672 N	6672 N	6672 N
CSBQG0300	5782 N	5782 N	5782 N	5782 N
CSBQG0400	6672 N	6672 N	6672 N	6672 N
CSBQG0500	N/A	N/A	N/A	N/A
CSBQG0600	6227 N	N/A	6227 N	N/A
CSBQG0800	6227 N	N/A	N/A	N/A

FM Loads					
Part Number	Service Pipe Schedule	Lateral			
		Horizontal Capacity per Installation Angle from Vertical			
		30° - 44°	45° - 59°	60° - 74°	75° - 90°
CSBQG0250EG/ CSBQG0250MEG	EN10255 L (Lightwall)	6270 N	8895 N	10900 N	12190 N
	EN10255 M (10)	6270 N	8895 N	10900 N	12190 N
	EN10255 H (40)	6270 N	8895 N	10900 N	12190 N
CSBQG0300EG	EN10255 L (Lightwall)	5295 N	7475 N	9163 N	10230 N
	EN10255 M (10)	5295 N	7475 N	9163 N	10230 N
	EN10255 H (40)	5295 N	7475 N	9163 N	10230 N
CSBQG0400EG	EN10255 L (Lightwall)	5295 N	7475 N	9163 N	10230 N
	EN10255 M (10)	5295 N	7475 N	9163 N	10230 N
	EN10255 H (40)	5295 N	7475 N	9163 N	10230 N
CSBQG0600EG	EN10255 L (Lightwall)	3870 N	5470 N	6715 N	7515 N
	EN10255 M (10)	3870 N	5470 N	6715 N	7515 N
	EN10255 H (40)	4315 N	6095 N	7475 N	8320 N
CSBQG0800EG	4.8 mm (Wall Thickness)	3515 N	4940 N	6050 N	6760 N
	EN10255 H (40)	3515 N	4940 N	6050 N	6760 N

## DIAGRAMS

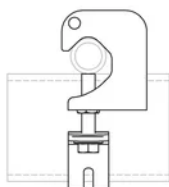
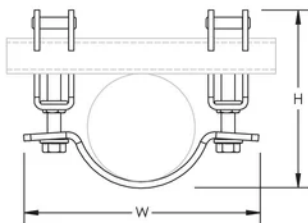

## WARNING

nVent products shall be installed and used only as indicated in nVent's product instruction sheets and training materials. Instruction sheets are available at [www.nvent.com](http://www.nvent.com) and from your nVent customer service representative. Improper installation, misuse, misapplication or other failure to completely follow nVent's instructions and warnings may cause product malfunction, property damage, serious bodily injury and death and/or void your warranty.



Our powerful portfolio of brands:

**CADDY   ERICO   HOFFMAN   ILSCO   SCHROFF   TRACHTE**