

# Hammer-On Flange Clip, Side Mount

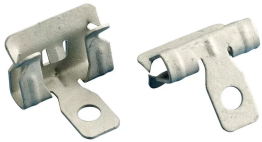

## CERTIFICATIONS



## FEATURES

Provides an attachment for wire, S-hooks, chain, nVent CADDY Speed Link or other assemblies to flanges and profiles

Fits most beams

Installs with just a hammer

## SPECIFICATIONS

Table 1/2

Catalog Number	Article Number	Material	Finish	Flange Thickness (FT)	Hole Size (HS)	Static Load
2H4	170010	Spring Steel	nVent CADDY Armour	2 - 3 mm	7.1 mm	700N
4H24R5	191018	Spring Steel	nVent CADDY Armour	3 - 8 mm	7.1 mm	900N
4H24S1	179610	Stainless Steel 301 (EN 1.4310)		3 - 8 mm	7.1 mm	650N
4H24SP25	172320	Spring Steel	nVent CADDY Armour	3 - 8 mm	7.1 mm	900N

CatalogNumber	Article Number	Material	Finish	Flange Thickness (FT)	Hole Size (HS)	Static Load
4H24	170020	Spring Steel	nVent CADDY Armour	3 - 8 mm	7.1 mm	900N
4H1318	170045	Spring Steel	nVent CADDY Armour	21 - 28 mm	7.1 mm	900N
4H58	170030	Spring Steel	nVent CADDY Armour	8 - 14 mm	7.1 mm	900N
4H58R5	191019	Spring Steel	nVent CADDY Armour	8 - 14 mm	7.1 mm	900N
4H58SP25	172350	Spring Steel	nVent CADDY Armour	8 - 14 mm	7.1 mm	900N
4H912	170040	Spring Steel	nVent CADDY Armour	14 - 20 mm	7.1 mm	900N
4H912R5	191045	Spring Steel	nVent CADDY Armour	14 - 20 mm	7.1 mm	900N
4H912SP25	172380	Spring Steel	nVent CADDY Armour	14 - 20 mm	7.1 mm	900N
4H58S1	179620	Stainless Steel 301 (EN 1.4310)		8 - 14 mm	7.1 mm	650N
4H912S1	179630	Stainless Steel 301 (EN 1.4310)		14 - 20 mm	7.1 mm	650N

Table 2/2

Catalog Number	Article Number	Certifications
2H4	170010	ITB, UL, cUL
4H24R5	191018	UL, cUL, CE, 4H, EM, EBC
4H24S1	179610	
4H24SP25	172320	CE, 4H, EM, EBC
4H24	170020	cUL, CE, 4H, EM, EBC, ITB, UL
4H1318	170045	UL, cUL

Catalog Number	Article Number	Certifications
4H58	170030	CE, 4H, EM, EBC, ITB, UL, cUL
4H58R5	191019	cUL, CE, 4H, EM, EBC, UL
4H58SP25	172350	CE, 4H, EM, EBC
4H912	170040	CE, 4H, EM, EBC, cUL, ITB, UL
4H912R5	191045	cUL, CE, 4H, EM, EBC, UL
4H912SP25	172380	CE, 4H, EM, EBC
4H58S1	179620	
4H912S1	179630	

## DIAGRAMS

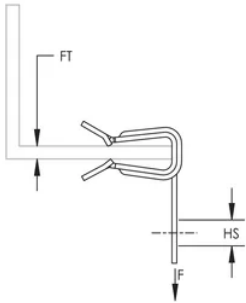

## WARNING

nVent products shall be installed and used only as indicated in nVent's product instruction sheets and training materials. Instruction sheets are available at [www.nvent.com](http://www.nvent.com) and from your nVent customer service representative. Improper installation, misuse, misapplication or other failure to completely follow nVent's instructions and warnings may cause product malfunction, property damage, serious bodily injury and death and/or void your warranty.

**North America**

+1.800.753.9221

Option 1 – Customer Care

Option 2 – Technical

Support

**Europe**

Netherlands:

+31 800-0200135

France:

+33 800 901 793

**Europe**

Germany:

800 1890272

Other Countries:

+31 13 5835404

**APAC**

Shanghai:

+ 86 21 2412 1618/19

Sydney:

+61 2 9751 8500



Our powerful portfolio of brands:

**CADDY ERICO HOFFMAN ILSCO SCHROFF TRACHTE**

