

Sealing Disk



Sealing disks are typically used in vertical pump fill applications, such as columns and shear walls. The sealing disk prevents bedding mortar from entering into the sleeve during installation and grout filling.

FEATURES

Rubber seal is designed to fit tightly around the reinforcing bar

Easy to install

SPECIFICATIONS

Material: Steel;Neoprene

Table 1/2

Catalog Number	Article Number	Rebar Size, Metric	Rebar Size, US	Rebar Size, Canada	Diameter 1 (Ø1)	Diameter 2 (Ø2)
LK608	145645	25 mm	#8	25M	92 mm	22.2 mm
LK607	145640	16 mm, 20 mm, 22 mm	#5, #6, #7	15M, 20M	89 mm	12.7 mm
LK614	145665	43 mm	#14	45M	105 mm	38.1 mm
LK610	145655	32 mm	#10		102 mm	28.6 mm
LK609	145650	28 mm	#9	30M	95 mm	25.4 mm
LK611	145660	36 mm	#11	35M	105 mm	28.6 mm

Table 2/2

Catalog Number	Article Number	Thickness (T)	Unit Weight	Package Quantity
LK608	145645	2 mm	0.03 kg	50
LK607	145640	2 mm	0.03 kg	50
LK614	145665	2 mm	0.04 kg	50
LK610	145655	2 mm	0.04 kg	50
LK609	145650	2 mm	0.04 kg	50
LK611	145660	2 mm	0.04 kg	50

ADDITIONAL PRODUCT DETAILS

Prior to installation, please read and understand the detailed instructions and safety notices provided in the nVent LENTON Interlok Instruction Manual.

DIAGRAMS

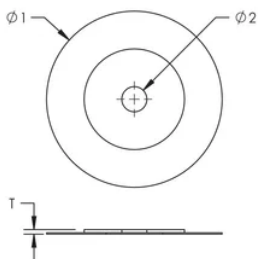

WARNING

nVent products shall be installed and used only as indicated in nVent's product instruction sheets and training materials. Instruction sheets are available at www.nvent.com and from your nVent customer service representative. Improper installation, misuse, misapplication or other failure to completely follow nVent's instructions and warnings may cause product malfunction, property damage, serious bodily injury and death and/or void your warranty.

North America

+1.800.753.9221

Option 1 – Customer Care

Option 2 – Technical

Support

Europe

Netherlands:

+31 800-0200135

France:

+33 800 901 793

Europe

Germany:

800 1890272

Other Countries:

+31 13 5835404

APAC

Shanghai:

+ 86 21 2412 1618/19

Sydney:

+61 2 9751 8500



Our powerful portfolio of brands:

CADDY

ERICO

HOFFMAN

ILSCO

SCHROFF

TRACHTE