

Rail Jumper Bond, Signal, XS Style



FEATURES

Provides unchanging electrical resistance

Superior corrosion resistance

XS style bond end terminals are tinned to prevent contamination prior to installation

Easy installation, with minimum installer training required

Simple and highly-portable installation equipment

Equally usable on old, worn, or new rails

Highly durable

SPECIFICATIONS

Table 1/2

Catalog Number	Material	Finish	Bond Terminal Style	Conductor Size	Length 1 (L1)	Length 2 (L2)
SBXSJ3324B	Cadmium Bronze, Copper	Bare, Tinned	XS	3/16" Bondstrand	609.6 mm	19.05 mm

Table 2/2

Catalog Number	Diameter (Ø)
SBXSJ3324B	4.8 mm

DIAGRAMS

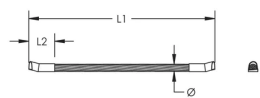

WARNING

nVent products shall be installed and used only as indicated in nVent's product instruction sheets and training materials. Instruction sheets are available at www.nvent.com and from your nVent customer service representative. Improper installation, misuse, misapplication or other failure to completely follow nVent's instructions and warnings may cause product malfunction, property damage, serious bodily injury and death and/or void your warranty.

⚠ WARNING: This product can expose you to chemicals including cadmium, which is known to the State of California to cause birth defects or other reproductive harm. For more information go to www.P65Warnings.ca.gov.

North America

+1.800.753.9221
Option 1 – Customer Care
Option 2 – Technical
Support

Europe

Netherlands:
+31 800-0200135
France:
+33 800 901 793

Europe

Germany:
800 1890272
Other Countries:
+31 13 5835404

APAC

Shanghai:
+ 86 21 2412 1618/19
Sydney:
+61 2 9751 8500



Our powerful portfolio of brands:

CADDY ERICO HOFFMAN ILSCO SCHROFF TRACHTE