

Plug Bond, Power, Welded Lug



FEATURES

Designed for application to the rail web

Hammered into a 3/8" (9.5 mm) diameter hole drilled through the rail web and driven from the same side the hole was drilled

SPECIFICATIONS

Insulation Thickness:	2.4 mm
Conductor Size:	14.5 mm Diameter
Material:	Copper;Steel;Copper Alloy;Carbon Steel;Elexar Rubber Thermoplastic Elastomer
Finish:	Electrogalvanized;Tinned;Pregalvanized

Table 1/2

Catalog Number	Length 1 (L1)	Length 2 (L2)	Length 3 (L3)	Width (W)	Depth (D)	Diameter 1 (Ø1)
PBP3S6D36	968.5 mm	81 mm	39.6mm	38.1 mm	29mm	14.5 mm
PBP3S6D40	1070.1 mm	81 mm	39.6mm	38.1 mm	29mm	14.5 mm

Table 2/2

Catalog Number	Diameter 2 (Ø2)	Hole Size (HS)	Slot Size (SS)
PBP3S6D36	10.5 mm	17.5 mm	17.5 x 20.5 mm

Catalog Number	Diameter 2 (Ø2)	Hole Size (HS)	Slot Size (SS)
PBP3S6D40	10.5 mm	17.5 mm	17.5 x 20.5 mm

ADDITIONAL PRODUCT DETAILS

Plug Bond Grease (T369) recommended when installing.

DIAGRAMS

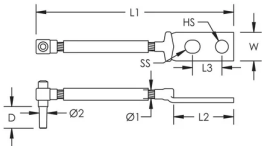

WARNING

nVent products shall be installed and used only as indicated in nVent's product instruction sheets and training materials. Instruction sheets are available at www.nvent.com and from your nVent customer service representative. Improper installation, misuse, misapplication or other failure to completely follow nVent's instructions and warnings may cause product malfunction, property damage, serious bodily injury and death and/or void your warranty.

North America

+1.800.753.9221
 Option 1 – Customer Care
 Option 2 – Technical Support

Europe

Netherlands:
 +31 800-0200135
 France:
 +33 800 901 793

Europe

Germany:
 800 1890272
 Other Countries:
 +31 13 5835404

APAC

Shanghai:
 + 86 21 2412 1618/19
 Sydney:
 +61 2 9751 8500



Our powerful portfolio of brands:

CADDY ERICO HOFFMAN ILSCO SCHROFF TRACHTE