

Front Handle One-Piece, Width 12.2 mm

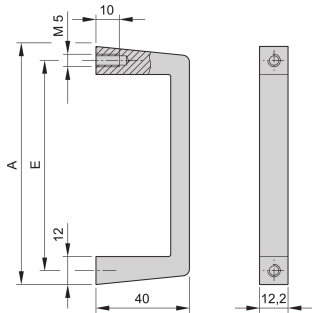

The handle can be assembled to a subrack or 19" front panel. Available with clear or black anodized surface. Handles will be bolted from the rear side.

CERTIFICATIONS



FEATURES

Static load-carrying capacity 30 kg/pair

Bolted from rear

SPECIFICATIONS

Material:	Aluminum
Product Family:	EuropacPRO
Product Type:	Handle
Works With:	Subracks

Table 1/2

Catalog Number	Rack Height	Finish	Package Quantity	Handle Type	Color	Torque
10501-116	1U	Anodized	1	Straight	Silver	
10501-004	2U	Anodized	1	Straight	Silver	

CatalogNumber	Rack Height	Finish	Package Quantity	Handle Type	Color	Torque
10501-005	3U	Anodized	1	Straight	Silver	2.4N·m
10501-006	4U	Anodized	1	Straight	Silver	
10501-007	5U	Anodized	1	Straight	Silver	
10501-008	6U	Anodized	1	Straight	Silver	2.4N·m
10501-016	2U	Anodized	1	Straight	Silver	
10501-018	4U	Anodized	1	Straight	Silver	2.4N·m
10501-020	3U	Anodized	1	Angled Handle	Silver	2.4N·m
10501-021	4U	Anodized	1	Angled Handle	Silver	2.4N·m
10501-022	6U	Anodized	1	Angled Handle	Silver	2.4N·m
10501-025	2U	Anodized	1	Straight	Black	
10501-026	3U	Anodized	1	Straight	Black	2.4N·m
10501-027	4U	Anodized	1	Straight	Black	
10501-028	5U	Anodized	1	Straight	Black	
10501-029	6U	Anodized	1	Straight	Black	2.4N·m

Table 2/2

Catalog Number	Quick Ship
10501-116	No
10501-004	No
10501-005	No

Catalog Number	Quick Ship
10501-006	No
10501-007	No
10501-008	No
10501-016	No
10501-018	No
10501-020	No
10501-021	No
10501-022	No
10501-025	No
10501-026	No
10501-027	No
10501-028	No
10501-029	No

ADDITIONAL PRODUCT DETAILS

Please order assembly part kit separately.

Please take into consideration that deliveries may be carried out in the stated SPQs (SPQ, e.g. 5 pieces, 10 pieces, 50 pieces, etc.). Differing order quantities (e.g. 2 pieces) may be changed to the next possible delivery quantity = Standard Pack Quantity.

WARNING

nVent products shall be installed and used only as indicated in nVent's product instruction sheets and training materials. Instruction sheets are available at www.nvent.com and from your nVent customer service representative. Improper installation, misuse, misapplication or other failure to completely follow nVent's instructions and warnings may cause product malfunction, property damage, serious bodily injury and death and/or void your warranty.

North America

All locations
+1.763.422.2661
Chat with us:
nvent.com/schroff

Europe

Straubenhardt, Germany
+49.7082.794.0
Betschdorf, France
+33.3.88.90.64.90
Warsaw, Poland
+48.22.209.98.35
Assago, Italy
+39.02.932.7141
Chat with us:
nvent.com/schroff

Asia

Shanghai, China
+86.21.2412.6943
Qingdao, China
+86.532.8771.6101
Singapore
+65.6768.5800
Shin-Yokohama, Japan
+81.45.476.0271
Chat with us:
nvent.com/schroff

Middle East & India

Dubai, United Arab Emirates
+971.4.378.1700
Bangalore, India
+91.80.6715.2001
Istanbul, Turkey
+90.216.250.7374
Chat with us:
nvent.com/schroff



Our powerful portfolio of brands:

CADDY ERICO HOFFMAN ILSCO SCHROFF TRACHTE