

# Snap Close Conductor Clamp



## FEATURES

For raised support and positioning of conductors

Snap-close installation requires no tools

## SPECIFICATIONS

**Material:** Nylon

Table 1/2

Catalog Number	Article Number	Conductor Size	Height (H)	Width (W)	A	Hole Size (HS)
SRL23N8	103710	8 mm Solid	25 mm	23 mm	23 mm	6.5 mm
SRL-23-N6	103700	6 mm Solid	25 mm	23 mm	23 mm	6.5 mm
SRL-23-N10	103720	10 mm Solid	25 mm	23 mm	23 mm	6.5 mm

Table 2/2

Catalog Number	Article Number	Unit Weight
SRL23N8	103710	0.01 kg
SRL-23-N6	103700	0.01 kg

Catalog Number	Article Number	Unit Weight
SRL-23-N10	103720	0.01 kg

## DIAGRAMS

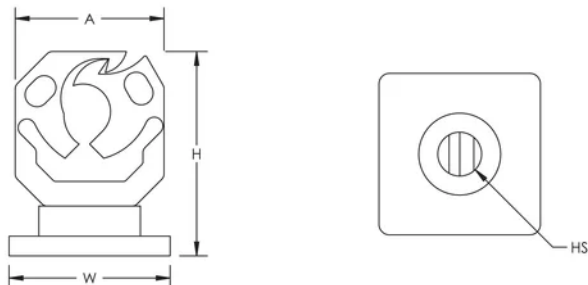

## WARNING

nVent products shall be installed and used only as indicated in nVent's product instruction sheets and training materials. Instruction sheets are available at [www.nvent.com](http://www.nvent.com) and from your nVent customer service representative. Improper installation, misuse, misapplication or other failure to completely follow nVent's instructions and warnings may cause product malfunction, property damage, serious bodily injury and death and/or void your warranty.

### North America

+1.800.753.9221  
Option 1 – Customer Care  
Option 2 – Technical  
Support

### Europe

Netherlands:  
+31 800-0200135  
France:  
+33 800 901 793

### Europe

Germany:  
800 1890272  
Other Countries:  
+31 13 5835404

### APAC

Shanghai:  
+ 86 21 2412 1618/19  
Sydney:  
+61 2 9751 8500



Our powerful portfolio of brands:

**CADDY ERICO HOFFMAN ILSCO SCHROFF TRACHTE**