

Cable to Web of Rail TB5 Complete Welder, Signal

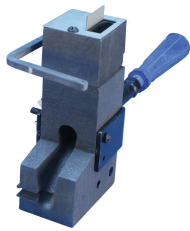

FEATURES

Complete right hand or left hand web welder assembly designed for the installation of track circuits and jumper bonds to the neutral axis of 85 to 141 lb. rail

SPECIFICATIONS

Bond Terminal Style:	1" Tab
Rail Type:	85 lb to 141 lb T-Rail Sections
Material:	Graphite;Steel;Thermoplastic

Table 1/1

Catalog Number	Conductor Size	Conductor Outer Diameter, Nominal	Welder Style	Orientation
SBWRTB5ALH	3/16" Bondstrand	4.76mm	TB5	Left Hand
SBWRTB5ARH	3/16" Bondstrand	4.76mm	TB5	Right Hand

WARNING

nVent products shall be installed and used only as indicated in nVent's product instruction sheets and training materials. Instruction sheets are available at www.nvent.com and from your nVent customer service representative. Improper installation, misuse, misapplication or other failure to completely follow nVent's instructions and warnings may cause product malfunction, property damage, serious bodily injury and death and/or void your warranty.

North America

+1.800.753.9221

Option 1 – Customer Care

Option 2 – Technical

Support

Europe

Netherlands:

+31 800-0200135

France:

+33 800 901 793

Europe

Germany:

800 1890272

Other Countries:

+31 13 5835404

APAC

Shanghai:

+ 86 21 2412 1618/19

Sydney:

+61 2 9751 8500



Our powerful portfolio of brands:

CADDY

ERICO

HOFFMAN

ILSCO

SCHROFF

TRACHTE