

# 2 Hole Lug, GL Style



## FEATURES

Provides an efficient bolting surface for grounding and power applications

Electrolytic grade copper

For use with nVent ERICO Cadweld type GL connections only

## SPECIFICATIONS

**Material:** Copper

**Type:** NEMA®

**Finish:** Tinned

Table 1/2

Catalog Number	Article Number	Height (H)	Length (L)	Width (W)	Thickness (T)	A
B122CE	183660	11.18 mm	81.03mm	25.4 mm	3.18 mm	15.9 mm
B122DE		11.18 mm	82.55mm	25.4 mm	4.76 mm	15.9 mm

Table 2/2

Catalog Number	Article Number	B	Hole Size (HS)	Angle (a)	Equivalent Conductor Size
B122CE	183660	44.45 mm	14.29 mm	90 °	80.63mm <sup>2</sup>

Catalog Number	Article Number	B	Hole Size (HS)	Angle (a)	Equivalent Conductor Size
B122DE		44.45 mm	14.29 mm	90 °	120.94mm <sup>2</sup>

### ADDITIONAL PRODUCT DETAILS

For sizes not listed, contact us.

### DIAGRAMS

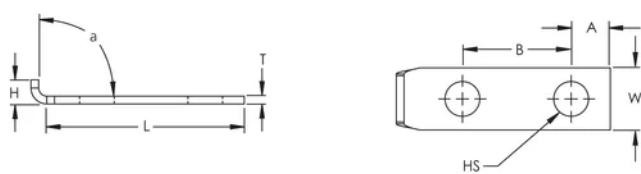

### WARNING

nVent products shall be installed and used only as indicated in nVent's product instruction sheets and training materials. Instruction sheets are available at [www.nvent.com](http://www.nvent.com) and from your nVent customer service representative. Improper installation, misuse, misapplication or other failure to completely follow nVent's instructions and warnings may cause product malfunction, property damage, serious bodily injury and death and/or void your warranty.

#### North America

+1.800.753.9221  
 Option 1 – Customer Care  
 Option 2 – Technical Support

#### Europe

Netherlands:  
 +31 800-0200135  
 France:  
 +33 800 901 793

#### Europe

Germany:  
 800 1890272  
 Other Countries:  
 +31 13 5835404

#### APAC

Shanghai:  
 + 86 21 2412 1618/19  
 Sydney:  
 +61 2 9751 8500



Our powerful portfolio of brands:

CADDY   ERICO   HOFFMAN   ILSCO   SCHROFF   TRACHTE