

Grub Screw

Power Utilities

For fixing the threaded insert in the horizontal rail.

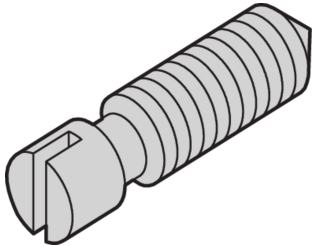

CERTIFICATIONS



FEATURES

Grub screw

SPECIFICATIONS

Table 1/2

Catalog Number	Length	Package Quantity	Thread Size	Material	Product Family	Product Type
21102-980	9 mm	100	M2.5	Stainless Steel		Screw
21100-276	8 mm	100	M2.5		EuropacPRO, RatiopacPRO, RatiopacPRO AIR, CompacPRO, PropacPRO, MultipacPRO	Screw

CatalogNumber	Length	Package Quantity	Thread Size	Material	Product Family	Product Type
21100-646	8 mm	100	M3		EuropacPRO, RatiopacPRO, RatiopacPRO AIR, CompacPRO, PropacPRO, MultipacPRO	Screw

Table 2/2

Catalog Number	Type	Works With	Torque	Certifications
21102-980	Grub Screw	Subracks, Cases, Chassis	0.37 N·m	
21100-276	Grub Screw	Subracks, Cases, Chassis		RoHS
21100-646	Grub Screw	Subracks, Cases, Chassis		RoHS

WARNING

nVent products shall be installed and used only as indicated in nVent's product instruction sheets and training materials. Instruction sheets are available at www.nvent.com and from your nVent customer service representative. Improper installation, misuse, misapplication or other failure to completely follow nVent's instructions and warnings may cause product malfunction, property damage, serious bodily injury and death and/or void your warranty.



Our powerful portfolio of brands:

CADDY ERICO HOFFMAN ILSCO SCHROFF TRACHTE