

# Uniklip Flat Elbow



## CERTIFICATIONS



## FEATURES

Creates a 90° horizontal change in cable tray direction

Provides optimal support for high-performance low voltage and data cables

Innovative UNIKLIP installation system that installs up to three times faster

IEC 61537 load rating and earthing compliant

No field cutting or modifications required; just drop it in and keep installing the cable tray

Eliminates safety related concerns around field cutting

Tool-free, integrated couplers with Uniklip

## SPECIFICATIONS

**Finish:** Pregalvanized

**Material:** Steel

Table 1/2

Catalog Number	Article Number	Width (W)	Depth (D)	Length (L)	Angle (a)	A
----------------	----------------	-----------	-----------	------------	-----------	---

PCT50X050FB90	850100	50 mm	49mm	550mm	90 °	167 mm
PCT50X075FB90	850110	75 mm	49mm	587mm	90 °	192 mm
PCT50X100FB90	850120	100 mm	49mm	622mm	90 °	216 mm
PCT50X150FB90	850130	150 mm	49mm	693mm	90 °	265 mm
PCT50X225FB90	850140	225 mm	49mm	799mm	90 °	340 mm
PCT50X300FB90	850150	300 mm	49mm	905mm	90 °	415 mm
PCT50X450FB90	850160	450 mm	49mm	1117mm	90 °	565 mm
PCT50X500FB90	850170	500 mm	49mm	972mm	90 °	590 mm
PCT50X600FB90	850180	600 mm	49mm	1329mm	90 °	715 mm

Table 2/2

Catalog Number	Article Number	B
PCT50X050FB90	850100	91 mm
PCT50X075FB90	850110	91 mm
PCT50X100FB90	850120	91 mm
PCT50X150FB90	850130	91 mm
PCT50X225FB90	850140	91 mm

Catalog Number	Article Number	B
PCT50X300FB90	850150	91 mm
PCT50X450FB90	850160	91 mm
PCT50X500FB90	850170	91 mm
PCT50X600FB90	850180	91 mm

## DIAGRAMS

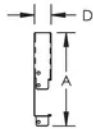
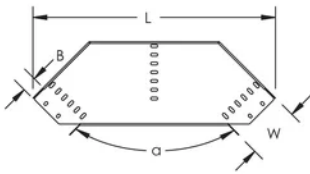

## WARNING

nVent products shall be installed and used only as indicated in nVent's product instruction sheets and training materials. Instruction sheets are available at [www.nvent.com](http://www.nvent.com) and from your nVent customer service representative. Improper installation, misuse, misapplication or other failure to completely follow nVent's instructions and warnings may cause product malfunction, property damage, serious bodily injury and death and/or void your warranty.

### North America

+1.800.753.9221  
Option 1 – Customer Care  
Option 2 – Technical  
Support

### Europe

Netherlands:  
+31 800-0200135  
France:  
+33 800 901 793

### Europe

Germany:  
800 1890272  
Other Countries:  
+31 13 5835404

### APAC

Shanghai:  
+ 86 21 2412 1618/19  
Sydney:  
+61 2 9751 8500



Our powerful portfolio of brands:

**CADDY ERICO HOFFMAN ILSCO SCHROFF TRACHTE**

