

# CPI Grounding and Bonding Braid, Stainless Steel

## Power Utilities



High-quality CPI stainless steel grounding and bonding braids can be installed in extremely corrosive environments, like offshore applications or coastal applications. The full range of CPI braids are ideal for applications using stainless steel pipe or tanks, like the food and beverage industry, building industry, transportation, oil and chemical industry.

nVent ERIFLEX offers 316L stainless steel braids and lugs, one of the highest resistant stainless steel options on the market. Our proprietary manufacturing process has been optimized to provide the best braiding, crimping, cutting and punching.

### CERTIFICATIONS



### FEATURES

Superior abrasion, corrosion, chemical and UV resistance make CPI braids ideal for outdoor applications

Great for expansion joints where constant movement requires a flexible and durable solution

Ready to use out of the box, eliminates the need for cutting, stripping, crimping and punching

Quick and easy to install

Resistant to vibration and fatigue, reducing maintenance

Will not rust or discolor, so the appearance will never fade or change

Excellent electrical contact

No additional lugs or terminals needed

Non-magnetic material

Recommended by the EMC/EMI directives

Performs to the class C5 (very high) category as per ISO@ 12944-2

EAC compliant

RoHS compliant

Compliant to ISO 6469-1 (Electrically propelled road vehicles - Part 1: Rechargeable energy storage system) - Section 6.2.2 Vibrations

## SPECIFICATIONS

Table 1/2

Catalog Number	Article Number	Certification Details	A	B	C	D
CPI16-150-8	554277	UL® 467	17.50 mm	20 mm	10 mm	3 mm

Table 2/2

Catalog Number	Article Number	Unit Weight
CPI16-150-8	554277	0.031 kg

## DIAGRAMS

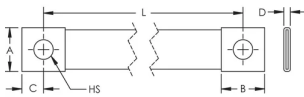

## WARNING

nVent products shall be installed and used only as indicated in nVent's product instruction sheets and training materials. Instruction sheets are available at [www.nvent.com](http://www.nvent.com) and from your nVent customer service representative. Improper installation, misuse, misapplication or other failure to completely follow nVent's instructions and warnings may cause product malfunction, property damage, serious bodily injury and death and/or void your warranty.



Our powerful portfolio of brands:

**CADDY ERICO HOFFMAN ILSCO SCHROFF TRACHTE**