

nVent ERIFLEX Flexbus Pre-assembled Supports

The nVent ERIFLEX Flexbus Pre-assembled Supports is a versatile, and user-friendly solution designed to complement your Flexbus installations. This innovative system is composed of a pre-assembled support and an aluminum profile, allowing it to accommodate multiple conductor configurations. Whether you need flat or on-edge positions, side-by-side or on top, this support system can be mounted directly to cable trays or on walls and ceilings.

The Flexbus Pre-assembled Supports are pre-mounted, guaranteeing substantial time savings during installation. By opting for these ready-to-go supports, you can reduce the total installation time for a Flexbus connection by approximately 20%.

This version of the Flexbus Supports features a single part number, with rails pre-cut to size and all components (inserts, threaded rods, bolts, and plastic modules) already mounted on the aluminum rail. No assembly is required. Simply mount the support on a cable tray or directly to the wall or ceiling. For standard Flexbus conductor routing, using these pre-assembled brackets significantly reduces installation time, making your setup process smoother and more efficient.

Engineered for reliability and safety, the nVent ERIFLEX Flexbus Pre-assembled Supports have been short-circuit tested and provides strong mechanical resistance to electromagnetic forces. It supports various neutral systems such as 3P or 3P+N and allows for easy routing in case of phase inversion or neutral rotation.



CERTIFICATIONS



FEATURES

Save even more installation time with Flexbus Pre-assembled Supports

Adjustable clip adapts to different conductor thicknesses with open and closed positions

Strong mechanical resistance and short-circuit tested as per IEC 61914 standards, withstanding up to 67kA rms and 147kA Peak

Suitable for 3P, 3P+N, and conductors in flat or on-edge configurations

Can be mounted on ceilings or walls

Designed to fit different types of cable trays

Can be mounted horizontally or vertically

SPECIFICATIONS

Insulation Voltage:	1000;1500
Dielectric Strength, IEC 61439.1:	3500 VAC @ 1 min
Finish:	Electrogalvanized
Material:	Glass Fibre Reinforced Polyamide;Steel
Complies With:	IEC® 60695-2-11 (Glow Wire Test 960 °C);IEC® 61439.1;IEC® 61914
Halogen Free Rating:	IEC® 60754-1
Low Smoke Rating:	ISO 5659-2
Flammability Rating:	UL® 94V-0
Working Temperature:	-40 to 130 °C

Table 1/2

Catalog Number	Article Number	Depth (D)	Width (W)	Height (H)	Conductor Size	Number of Phases
FLEXSUEDG100 T1	508604	78mm	375mm	176mm	800 mm², 960 mm², 1280 mm², 1810 mm²	3
FLEXSUEDG100 TN1	508606	78mm	475mm	176mm	800 mm², 960 mm², 1280 mm², 1810 mm²	3
FLEXSUEDG50T 1	508600	78mm	337.5mm	126mm	220 mm², 360 mm², 545 mm², 640 mm²	3
FLEXSUEDG50T N1	508602	78mm	425mm	126mm	220 mm², 360 mm², 545 mm², 640 mm²	3
FLEXSUFLA100 T1	508612	78mm	487.5mm	130mm	800 mm², 960 mm², 1280 mm², 1810 mm²	3
FLEXSUFLA100 TN1	508614	78mm	625mm	130mm	800 mm², 960 mm², 1280 mm², 1810 mm²	3

CatalogNumber	Article Number	Depth (D)	Width (W)	Height (H)	Conductor Size	Number of Phases
FLEXSUFLA50T 1	508608	78mm	337.5mm	126mm	220 mm ² , 360 mm ² , 545 mm ² , 640 mm ²	3
FLEXSUFLA50T N1	508610	78mm	425mm	126mm	220 mm ² , 360 mm ² , 545 mm ² , 640 mm ²	3
FLEXSUEDG100 T2	508605	78mm	375mm	340mm	800 mm ² , 960 mm ² , 1280 mm ² , 1810 mm ²	3
FLEXSUEDG100 TN2	508607	78mm	475mm	340mm	800 mm ² , 960 mm ² , 1280 mm ² , 1810 mm ²	3
FLEXSUEDG50T 2	508601	78mm	337.5mm	240mm	220 mm ² , 360 mm ² , 545 mm ² , 640 mm ²	3
FLEXSUEDG50T N2	508603	78mm	425mm	240mm	220 mm ² , 360 mm ² , 545 mm ² , 640 mm ²	3
FLEXSUFLA100 T2	508613	78mm	487.5mm	248mm	800 mm ² , 960 mm ² , 1280 mm ² , 1810 mm ²	3
FLEXSUFLA100 TN2	508615	78mm	625mm	248mm	800 mm ² , 960 mm ² , 1280 mm ² , 1810 mm ²	3
FLEXSUFLA50T 2	508609	78mm	337.5mm	240mm	220 mm ² , 360 mm ² , 545 mm ² , 640 mm ²	3
FLEXSUFLA50T N2	508611	78mm	425mm	240mm	220 mm ² , 360 mm ² , 545 mm ² , 640 mm ²	3

Table 2/2

Catalog Number	Article Number	Conductor Quantity	Orientation	Unit Weight
FLEXSUEDG100T1	508604	1	On Edge	1.87 kg
FLEXSUEDG100TN1	508606	1	On Edge	2.44 kg

Catalog Number	Article Number	Conductor Quantity	Orientation	Unit Weight
FLEXSUEDG50T1	508600	1	On Edge	1.4 kg
FLEXSUEDG50TN1	508602	1	On Edge	1.77 kg
FLEXSUFLA100T1	508612	1	Flat	1.93 kg
FLEXSUFLA100TN1	508614	1	Flat	2.49 kg
FLEXSUFLA50T1	508608	1	Flat	1.34 kg
FLEXSUFLA50TN1	508610	1	Flat	1.69 kg
FLEXSUEDG100T2	508605	2	On Edge	3.46 kg
FLEXSUEDG100TN2	508607	2	On Edge	4.54 kg
FLEXSUEDG50T2	508601	2	On Edge	2.49 kg
FLEXSUEDG50TN2	508603	2	On Edge	3.17 kg
FLEXSUFLA100T2	508613	2	Flat	3.48 kg
FLEXSUFLA100TN2	508615	2	Flat	4.52 kg
FLEXSUFLA50T2	508609	2	Flat	2.37 kg
FLEXSUFLA50TN2	508611	2	Flat	3.01 kg

Installation Standard: AS 3008;BS 7671;CEI 64-8;CSN;DIN VDE 0100;HD 384;IEC® 60364

ADDITIONAL PRODUCT DETAILS

When using a cable tray, we recommend installing a Flexbus Support at each end to protect the Flexbus Conductor from potential sharp edges.

For easier installation of the Flexbus Conductors on cable trays, we suggest using cantilever systems to provide easy and direct access during the installation phases.

DIAGRAMS

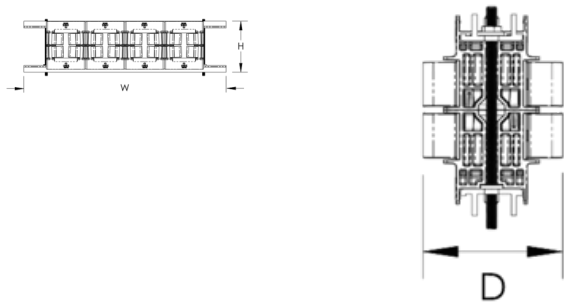

WARNING

nVent products shall be installed and used only as indicated in nVent's product instruction sheets and training materials. Instruction sheets are available at www.nvent.com and from your nVent customer service representative. Improper installation, misuse, misapplication or other failure to completely follow nVent's instructions and warnings may cause product malfunction, property damage, serious bodily injury and death and/or void your warranty.

North America

+1.800.753.9221
Option 1 – Customer Care
Option 2 – Technical
Support

Europe

Netherlands:
+31 800-0200135
France:
+33 800 901 793

Europe

Germany:
800 1890272
Other Countries:
+31 13 5835404

APAC

Shanghai:
+ 86 21 2412 1618/19
Sydney:
+61 2 9751 8500



Our powerful portfolio of brands:

CADDY ERICO HOFFMAN ILSCO SCHROFF TRACHTE