

# Early Streamer Emission Terminal Water Pipe Mast Adaptor



## FEATURES

Mounts Early Streamer Emission Terminals to non-insulated steel pipes, using the pipes as downconductor

## SPECIFICATIONS

Table 1/2

Catalog Number	Material	Finish	Thread Size 1 (TS1)	Thread Size 2 (TS2)	Diameter (Ø)	Height (H)
INTCPTADF2BS PSI	Steel, Stainless Steel 304 (EN 1.4301)	Hot-Dip Galvanized	MF25	2" BSPT	75.2 mm	93.7 mm

Table 2/2

Catalog Number	Unit Weight
INTCPTADF2BSPSI	0.68 kg

## DIAGRAMS

---

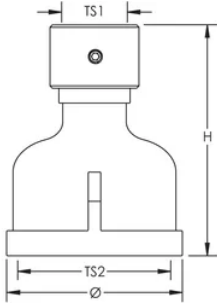

## WARNING

---

nVent products shall be installed and used only as indicated in nVent's product instruction sheets and training materials. Instruction sheets are available at [www.nvent.com](http://www.nvent.com) and from your nVent customer service representative. Improper installation, misuse, misapplication or other failure to completely follow nVent's instructions and warnings may cause product malfunction, property damage, serious bodily injury and death and/or void your warranty.

### North America

+1.800.753.9221

Option 1 – Customer Care

Option 2 – Technical

Support

### Europe

Netherlands:

+31 800-0200135

France:

+33 800 901 793

### Europe

Germany:

800 1890272

Other Countries:

+31 13 5835404

### APAC

Shanghai:

+ 86 21 2412 1618/19

Sydney:

+61 2 9751 8500



Our powerful portfolio of brands:

**CADDY**

**ERICO**

**HOFFMAN**

**ILSCO**

**SCHROFF**

**TRACHTE**