

Plug Bond, Signal



FEATURES

Designed for application to the rail web

Hammered into a 3/8" (9.5 mm) diameter hole drilled through the rail web and driven from the same side the hole was drilled

Recommended method of installation requires a bond 12" (304.8 mm) longer than the splice bar

SPECIFICATIONS

Table 1/2

Catalog Number	Material	Finish	Conductor Size	Length (L)	Diameter 1 (Ø1)	Diameter 2 (Ø2)
SBPAJ332	Cadmium Bronze, Carbon Steel	Electrogalvanized, Bare	3/16" Bondstrand	812.8mm	4.8 mm	10.5 mm
SBPAJ333	Cadmium Bronze, Carbon Steel	Electrogalvanized, Bare	3/16" Bondstrand	838.2mm	4.8 mm	10.5 mm
SBPAJ336	Cadmium Bronze, Carbon Steel	Electrogalvanized, Bare	3/16" Bondstrand	914.4mm	4.8 mm	10.5 mm
SBPAJ345	Cadmium Bronze, Carbon Steel	Electrogalvanized, Bare	3/16" Bondstrand	1143mm	4.8 mm	10.5 mm
SBPAJ346	Cadmium Bronze, Carbon Steel	Electrogalvanized, Bare	3/16" Bondstrand	1168.4mm	4.8 mm	10.5 mm

CatalogNumber	Material	Finish	Conductor Size	Length (L)	Diameter 1(Ø1)	Diameter 2(Ø2)
SBPAJ348	Cadmium Bronze, Carbon Steel	Electrogalvaniz ed, Bare	3/16" Bondstrand	1219.2mm	4.8 mm	10.5 mm
SBPAJ396	Cadmium Bronze, Carbon Steel	Electrogalvaniz ed, Bare	3/16" Bondstrand	2438mm	4.8 mm	10.5 mm
SBPAJG156	Stainless Steel 302 (EN 1.4324), Cadmium Bronze, Carbon Steel	Electrogalvaniz ed, Bare	1/4" Bondstrand	3962.4mm	6.4 mm	10.5 mm
SBPAJG34	Stainless Steel 302 (EN 1.4324), Cadmium Bronze, Carbon Steel	Electrogalvaniz ed, Bare	1/4" Bondstrand	863.6mm	6.4 mm	10.5 mm
SBPAJG36	Stainless Steel 302 (EN 1.4324), Cadmium Bronze, Carbon Steel	Electrogalvaniz ed, Bare	1/4" Bondstrand	914.4mm	6.4 mm	10.5 mm
SBPAJG48	Stainless Steel 302 (EN 1.4324), Cadmium Bronze, Carbon Steel	Electrogalvaniz ed, Bare	1/4" Bondstrand	1219.2mm	6.4 mm	10.5 mm
SBPAJ537	Cadmium Bronze, Carbon Steel	Electrogalvaniz ed, Bare	5/16" Bondstrand	939.8mm	7.9 mm	10.5 mm
SBPAJ548	Cadmium Bronze, Carbon Steel	Electrogalvaniz ed, Bare	5/16" Bondstrand	1219.2mm	7.9 mm	10.5 mm
SBPAJA30	Copper, Steel, Carbon Steel	Electrogalvaniz ed, Tinned, Pregalvanized	0.330" Diameter	762mm	8.4 mm	10.5 mm
SBPAJA34	Copper, Steel, Carbon Steel	Electrogalvaniz ed, Tinned, Pregalvanized	0.330" Diameter	863.6mm	8.4 mm	10.5 mm
SBPAJA36	Copper, Steel, Carbon Steel	Electrogalvaniz ed, Tinned, Pregalvanized	0.330" Diameter	914.4mm	8.4 mm	10.5 mm

CatalogNumber	Material	Finish	Conductor Size	Length (L)	Diameter 1(Ø1)	Diameter 2(Ø2)
SBPAJA42	Copper, Steel, Carbon Steel	Electrogalvanized, Tinned, Pregalvanized	0.330" Diameter	1066.8mm	8.4 mm	10.5 mm
SBPAJA48	Copper, Steel, Carbon Steel	Electrogalvanized, Tinned, Pregalvanized	0.330" Diameter	1219.2mm	8.4 mm	10.5 mm
SBPAJA60	Copper, Steel, Carbon Steel	Electrogalvanized, Tinned, Pregalvanized	0.330" Diameter	1524mm	8.4 mm	10.5 mm
SBPAJB120	Copper, Steel, Carbon Steel	Electrogalvanized, Tinned, Pregalvanized	0.334" Diameter	3048mm	8.5 mm	10.5 mm
SBPAJB24	Copper, Steel, Carbon Steel	Electrogalvanized, Tinned, Pregalvanized	0.334" Diameter	609.6mm	8.5 mm	10.5 mm
SBPAJB30	Copper, Steel, Carbon Steel	Electrogalvanized, Tinned, Pregalvanized	0.334" Diameter	762mm	8.5 mm	10.5 mm
SBPAJB32	Copper, Steel, Carbon Steel	Electrogalvanized, Tinned, Pregalvanized	0.334" Diameter	812.8mm	8.5 mm	10.5 mm
SBPAJB34	Copper, Steel, Carbon Steel	Electrogalvanized, Tinned, Pregalvanized	0.334" Diameter	863.6mm	8.5 mm	10.5 mm
SBPAJB36	Copper, Steel, Carbon Steel	Electrogalvanized, Tinned, Pregalvanized	0.334" Diameter	914.4mm	8.5 mm	10.5 mm
SBPAJB42	Copper, Steel, Carbon Steel	Electrogalvanized, Tinned, Pregalvanized	0.334" Diameter	1066.8mm	8.5 mm	10.5 mm
SBPAJB44	Copper, Steel, Carbon Steel	Electrogalvanized, Tinned, Pregalvanized	0.334" Diameter	1117.6mm	8.5 mm	10.5 mm
SBPAJB46	Copper, Steel, Carbon Steel	Electrogalvanized, Tinned, Pregalvanized	0.334" Diameter	1168.4mm	8.5 mm	10.5 mm
SBPAJB48	Copper, Steel, Carbon Steel	Electrogalvanized, Tinned, Pregalvanized	0.334" Diameter	1219.2mm	8.5 mm	10.5 mm
SBPAJB60	Copper, Steel, Carbon Steel	Electrogalvanized, Tinned, Pregalvanized	0.334" Diameter	1524mm	8.5 mm	10.5 mm
SBPAJB72	Copper, Steel, Carbon Steel	Electrogalvanized, Tinned, Pregalvanized	0.334" Diameter	1828.8mm	8.5 mm	10.5 mm

Table 2/2

Catalog Number	Depth (D)
SBPAJ332	31 3/4mm
SBPAJ333	31 3/4mm
SBPAJ336	31 3/4mm
SBPAJ345	31 3/4mm
SBPAJ346	31 3/4mm
SBPAJ348	31 3/4mm
SBPAJ396	31 3/4mm
SBPAJG156	31 3/4mm
SBPAJG34	31 3/4mm
SBPAJG36	31 3/4mm
SBPAJG48	31 3/4mm
SBPAJ537	31 3/4mm
SBPAJ548	31 3/4mm
SBPAJA30	31 3/4mm
SBPAJA34	31 3/4mm
SBPAJA36	31 3/4mm
SBPAJA42	31 3/4mm
SBPAJA48	31 3/4mm

Catalog Number	Depth (D)
SBPAJA60	31 3/4mm
SBPAJB120	31 3/4mm
SBPAJB24	31 3/4mm
SBPAJB30	31 3/4mm
SBPAJB32	31 3/4mm
SBPAJB34	31 3/4mm
SBPAJB36	31 3/4mm
SBPAJB42	31 3/4mm
SBPAJB44	31 3/4mm
SBPAJB46	31 3/4mm
SBPAJB48	31 3/4mm
SBPAJB60	31 3/4mm
SBPAJB72	31 3/4mm

ADDITIONAL PRODUCT DETAILS

Plug Bond Grease (T369) recommended when installing.

DIAGRAMS

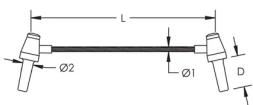

WARNING

nVent products shall be installed and used only as indicated in nVent's product instruction sheets and training materials. Instruction sheets are available at www.nvent.com and from your nVent customer service representative. Improper installation, misuse, misapplication or other failure to completely follow nVent's instructions and warnings may cause product malfunction, property damage, serious bodily injury and death and/or void your warranty.

⚠ WARNING: This product can expose you to chemicals including cadmium, which is known to the State of California to cause birth defects or other reproductive harm. For more information go to www.P65Warnings.ca.gov.

North America

+1.800.753.9221

Option 1 – Customer Care

Option 2 – Technical

Support

Europe

Netherlands:

+31 800-0200135

France:

+33 800 901 793

Europe

Germany:

800 1890272

Other Countries:

+31 13 5835404

APAC

Shanghai:

+ 86 21 2412 1618/19

Sydney:

+61 2 9751 8500



Our powerful portfolio of brands:

CADDY

ERICO

HOFFMAN

ILSCO

SCHROFF

TRACHTE