

# Sealing Disk



Sealing disks are typically used in vertical pump fill applications, such as columns and shear walls. The sealing disk prevents bedding mortar from entering into the sleeve during installation and grout filling.

## FEATURES

Rubber seal is designed to fit tightly around the reinforcing bar

Easy to install

## SPECIFICATIONS

**Material:** Steel;Neoprene

Table 1/2

Catalog Number	Rebar Size, Metric	Rebar Size, US	Rebar Size, Canada	Diameter 1 (Ø1)	Diameter 2 (Ø2)	Thickness (T)
LK607	16 mm, 20 mm	#5, #6, #7	15M, 20M	89 mm	12.7 mm	2 mm
LK608	25 mm	#8	25M	92 mm	22.2 mm	2 mm
LK614	43 mm	#14	45M	105 mm	38.1 mm	2 mm
LK611	36 mm	#11	35M	105 mm	28.6 mm	2 mm
LK610	32 mm	#10		102 mm	28.6 mm	2 mm
LK609	28 mm	#9	30M	95 mm	25.4 mm	2 mm

Table 2/2

Catalog Number	Unit Weight
LK607	0.03 kg
LK608	0.03 kg
LK614	0.04 kg
LK611	0.04 kg
LK610	0.04 kg
LK609	0.04 kg

## ADDITIONAL PRODUCT DETAILS

Prior to installation, please read and understand the detailed instructions and safety notices provided in the nVent LENTON Interlok Instruction Manual.

## DIAGRAMS

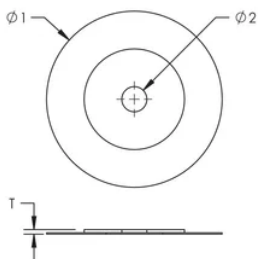

## WARNING

nVent products shall be installed and used only as indicated in nVent's product instruction sheets and training materials. Instruction sheets are available at [www.nvent.com](http://www.nvent.com) and from your nVent customer service representative. Improper installation, misuse, misapplication or other failure to completely follow nVent's instructions and warnings may cause product malfunction, property damage, serious bodily injury and death and/or void your warranty.

#### North America

+1.800.753.9221

Option 1 – Customer Care

Option 2 – Technical

Support

#### Europe

Netherlands:

+31 800-0200135

France:

+33 800 901 793

#### Europe

Germany:

800 1890272

Other Countries:

+31 13 5835404

#### APAC

Shanghai:

+ 86 21 2412 1618/19

Sydney:

+61 2 9751 8500



Our powerful portfolio of brands:

**CADDY**

**ERICO**

**HOFFMAN**

**ILSCO**

**SCHROFF**

**TRACHTE**