

ELFM Female-to-Male Extension



nVent LENTON ELFM Female-to-Male Extensions are a unique problem solver for the nVent LENTON taper-threaded splicing system. The extensions are ordered to customer specified lengths and are machined to have a female nVent LENTON taper thread on one end and a male nVent LENTON taper thread on the other. These extensions can be used in conjunction with the entire nVent LENTON taper threaded coupler product line to increase the length of either the reinforcing steel or nVent LENTON couplers.

FEATURES

Small diameter reduces concrete cover and eliminates reinforcing steel bar (rebar) congestion

Tapered thread helps prevent cross-threading and provides a positive locking, no-slip connection

Installs quickly, taking approximately four and one-half turns to engage

No special tools or skills required

Available in customer specified lengths

SPECIFICATIONS

Finish: Plain

Material: Steel

Table 1/2

Catalog Number	Rebar Size, Metric	Rebar Size, US	Rebar Size, Canada	Diameter (Ø)	Length (L)	Bar Depth (BD)
EL25F25M125N	25 mm	#8	25M	35 mm	125mm	40mm
EL28F28M130N	28 mm	#9	30M	40 mm	130mm	42mm
EL32F32M138N	32 mm	#10		45 mm	138mm	45mm

Table 2/2

Catalog Number	Unit Weight	Package Quantity
----------------	-------------	------------------

EL25F25M125N	0.6 kg	30
EL28F28M130N	0.8 kg	20
EL32F32M138N	1 kg	15

Designed to Meet: AASHTO;ABNT NBR 8548:1984;ACI 318 Type 1 (125% Specified Yield);ACI 318 Type 2 (Specified Tensile);ACI 349;ACI 359;AS3600

ADDITIONAL PRODUCT DETAILS

Bar dimensions and weights listed may vary by region. Coupler sizes not shown may be available by special order. Contact your nVent LENTON representative for more information.

DIAGRAMS

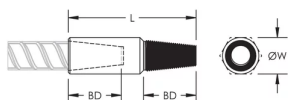

WARNING

nVent products shall be installed and used only as indicated in nVent's product instruction sheets and training materials. Instruction sheets are available at www.nvent.com and from your nVent customer service representative. Improper installation, misuse, misapplication or other failure to completely follow nVent's instructions and warnings may cause product malfunction, property damage, serious bodily injury and death and/or void your warranty.

North America

+1.800.753.9221
Option 1 – Customer Care
Option 2 – Technical
Support

Europe

Netherlands:
+31 800-0200135
France:
+33 800 901 793

Europe

Germany:
800 1890272
Other Countries:
+31 13 5835404

APAC

Shanghai:
+ 86 21 2412 1618/19
Sydney:
+61 2 9751 8500



Our powerful portfolio of brands:

CADDY ERICO HOFFMAN ILSCO SCHROFF TRACHTE