

# A2 Standard Coupler, Plain



## CERTIFICATIONS



## FEATURES

Designed to splice the same diameter bars where the second bar can be rotated and is not restricted in its axial direction

Slim design maintains concrete cover

Installs quickly and easily

## SPECIFICATIONS

<b>Finish:</b>	Plain
<b>Coupler Protector:</b>	Standard
<b>Material:</b>	Steel
<b>100% U.S. Domestic Content:</b>	Yes

Table 1/2

Catalog Number	Rebar Size, Metric	Rebar Size, US	Rebar Size, Canada	Hex Width (W)	Diameter (Ø)	Length (L)
EL12A2	12 mm	#4	10M	17 mm		41mm
EL16A2	16 mm	#5	15M	22 mm		56mm

CatalogNumber	Rebar Size, Metric	Rebar Size, US	Rebar Size, Canada	Hex Width (W)	Diameter (Ø)	Length (L)
EL20A2	20 mm	#6	20M	27 mm		71mm
EL22A2	22 mm	#7		30 mm		80mm
EL25A2	25 mm	#8	25M		35 mm	85mm
EL28A2	28 mm	#9	30M		38 mm	91mm
EL36A2	36 mm	#11	35M		48 mm	101mm
EL32A2	32 mm	#10			44 mm	96mm
EL38A2	38 mm	#12			51 mm	105mm
EL40A2	40 mm				57 mm	127mm
EL43TA2	43 mm	#14	45M		57 mm	133mm
EL50TA2	50 mm				70 mm	163mm
EL57TA2	57 mm	#18	55M		76 mm	164mm

Table 2/2				
Catalog Number	Bar Depth (BD)	Bar Gap (BG)	Unit Weight	Certifications
EL12A2	15mm	11mm	0.06 kg	LA City Approval, IAPMO®-UES
EL16A2	22mm	12mm	0.12 kg	IAPMO®-UES, LA City Approval
EL20A2	28mm	15mm	0.23 kg	LA City Approval, IAPMO®-UES
EL22A2	32mm	16mm	0.33 kg	LA City Approval, IAPMO®-UES
EL25A2	34mm	17mm	0.39 kg	LA City Approval, IAPMO®-UES
EL28A2	38mm	15mm	0.48 kg	LA City Approval, IAPMO®-UES

Catalog Number	Bar Depth (BD)	Bar Gap (BG)	Unit Weight	Certifications
EL36A2	43mm	15mm	0.8 kg	LA City Approval, IAPMO®-UES
EL32A2	40mm	16mm	0.69 kg	LA City Approval, IAPMO®-UES
EL38A2	44mm	17mm	0.95 kg	
EL40A2	55mm	17mm	1.55 kg	LA City Approval, IAPMO®-UES
EL43TA2	56mm	21mm	1.52 kg	LA City Approval, IAPMO®-UES
EL50TA2	71mm	21mm	2.81 kg	IAPMO®-UES, LA City Approval
EL57TA2	71mm	22mm	3.32 kg	LA City Approval, IAPMO®-UES

**Designed to Meet:** AASHTO;ABNT NBR 8548:1984;ACI 318 Type 1 (125% Specified Yield);ACI 318 Type 2 (Specified Tensile);ACI 349;ACI 359;AS3600

## ADDITIONAL PRODUCT DETAILS

Bar dimensions and weights listed may vary by region. Coupler sizes not shown may be available by special order. Contact your nVent LENTON representative for more information.

## DIAGRAMS

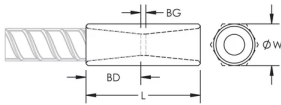

## WARNING

nVent products shall be installed and used only as indicated in nVent's product instruction sheets and training materials. Instruction sheets are available at [www.nvent.com](http://www.nvent.com) and from your nVent customer service representative. Improper installation, misuse, misapplication or other failure to completely follow nVent's instructions and warnings may cause product malfunction, property damage, serious bodily injury and death and/or void your warranty.

#### North America

+1.800.753.9221

Option 1 – Customer Care

Option 2 – Technical

Support

#### Europe

Netherlands:

+31 800-0200135

France:

+33 800 901 793

#### Europe

Germany:

800 1890272

Other Countries:

+31 13 5835404

#### APAC

Shanghai:

+ 86 21 2412 1618/19

Sydney:

+61 2 9751 8500



Our powerful portfolio of brands:

**CADDY**

**ERICO**

**HOFFMAN**

**ILSCO**

**SCHROFF**

**TRACHTE**