

# TCB Threaded Busbar



## CERTIFICATIONS



## FEATURES

Heavy-duty power connection

Circuit breaker, generator and prefabricated power network conductor

Alternative to large and multiple cables

Earth/ground connection

Power distribution

Rounded edges

## SPECIFICATIONS

**Material:** Copper

Table 1/2

Catalog Number	Article Number	Width (W)	Thickness (T)	Length (L)	Thread Size (TS)	Torque (TQ)
TCB12X2-1M	549230	12 mm	2 mm	990mm	M5	1.3 N·m

CatalogNumber	Article Number	Width (W)	Thickness (T)	Length (L)	Thread Size (TS)	Torque (TQ)
TCB12X4-1M	550200	12 mm	4 mm	990mm	M5	2 N·m
TCB12X4-2M	550190	12 mm	4 mm	1985mm	M5	2 N·m
TCB18X4-1M	549200	18 mm	4 mm	1000mm	M8	11 N·m
TCB25X4-1M	549210	25 mm	4 mm	1000mm	M6	4.5 N·m
TCB12X5-1M	549220	12 mm	5 mm	990mm	M5	5.5 N·m

Table 2/2

Catalog Number	Article Number	A	Unit Weight
TCB12X2-1M	549230	18 mm	0.3 kg
TCB12X4-1M	550200	18 mm	0.43 kg
TCB12X4-2M	550190	18 mm	0.85 kg
TCB18X4-1M	549200	20 mm	0.6 kg
TCB25X4-1M	549210	20 mm	0.8 kg
TCB12X5-1M	549220	18 mm	0.5 kg

## DIAGRAMS

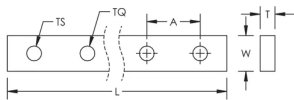

## WARNING

nVent products shall be installed and used only as indicated in nVent's product instruction sheets and training materials. Instruction sheets are available at [www.nvent.com](http://www.nvent.com) and from your nVent customer service representative. Improper installation, misuse, misapplication or other failure to completely follow nVent's instructions and warnings may cause product malfunction, property damage, serious bodily injury and death and/or void your warranty.

#### North America

+1.800.753.9221

Option 1 – Customer Care

Option 2 – Technical

Support

#### Europe

Netherlands:

+31 800-0200135

France:

+33 800 901 793

#### Europe

Germany:

800 1890272

Other Countries:

+31 13 5835404

#### APAC

Shanghai:

+ 86 21 2412 1618/19

Sydney:

+61 2 9751 8500



Our powerful portfolio of brands:

**CADDY**

**ERICO**

**HOFFMAN**

**ILSCO**

**SCHROFF**

**TRACHTE**