

Air Terminal Base, Vertical Mount with Offset, Imperial Thread

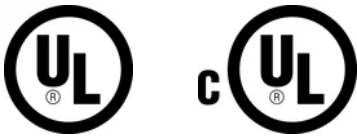

CERTIFICATIONS



FEATURES

For use on vertical surfaces

Offset provides clearance for overhang of wall cap or cover

Accommodates vertical or horizontal cable runs

For positive bolt tension cable clamping

SPECIFICATIONS

Conductor Size, UL: Class 1 - Class 2 (4/0 Max)

Table 1/2

Catalog Number	Material	Finish	Thread Size (TS)	Depth (D)	Height (H)	Width (W)
LPA31958	Aluminum	Bare	5/8" UNC	59.53mm	79.38 mm	79.38 mm
LPC31912	Copper	Bare	1/2" UNC	59.53mm	79.38 mm	79.38 mm

CatalogNumber	Material	Finish	Thread Size (TS)	Depth (D)	Height (H)	Width (W)
LPC31938	Copper	Bare	3/8" UNC	59.53mm	79.38 mm	79.38 mm
LPC31958	Copper	Bare	5/8" UNC	59.53mm	79.38 mm	79.38 mm
LPC319L12	Copper	Tinned	1/2" UNC	59.53mm	79.38 mm	79.38 mm
LPC319L38	Copper	Tinned	3/8" UNC	59.53mm	79.38 mm	79.38 mm
LPC319L58	Copper	Tinned	5/8" UNC	59.53mm	79.38 mm	79.38 mm

Table 2/2

Catalog Number	Hole Size (HS)	A	Unit Weight
LPA31958	12.7 mm	38.1 mm	0.13 kg
LPC31912	12.7 mm	38.1 mm	0.38 kg
LPC31938	12.7 mm	38.1 mm	0.38 kg
LPC31958	12.7 mm	38.1 mm	0.38 kg
LPC319L12	12.7 mm	38.1 mm	0.38 kg
LPC319L38	12.7 mm	38.1 mm	0.38 kg
LPC319L58	12.7 mm	38.1 mm	0.38 kg

DIAGRAMS

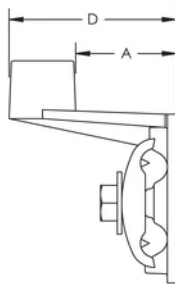
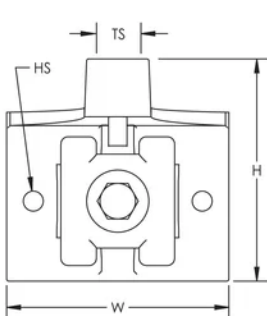

WARNING

nVent products shall be installed and used only as indicated in nVent's product instruction sheets and training materials. Instruction sheets are available at www.nvent.com and from your nVent customer service representative. Improper installation, misuse, misapplication or other failure to completely follow nVent's instructions and warnings may cause product malfunction, property damage, serious bodily injury and death and/or void your warranty.

⚠ WARNING: This product can expose you to chemicals including lead, which is known to the State of California to cause cancer and birth defects or other reproductive harm. For more information go to www.P65Warnings.ca.gov.

North America

+1.800.753.9221

Option 1 – Customer Care

Option 2 – Technical

Support

Europe

Netherlands:

+31 800-0200135

France:

+33 800 901 793

Europe

Germany:

800 1890272

Other Countries:

+31 13 5835404

APAC

Shanghai:

+ 86 21 2412 1618/19

Sydney:

+61 2 9751 8500



Our powerful portfolio of brands:

CADDY

ERICO

HOFFMAN

ILSCO

SCHROFF

TRACHTE